

THE BEST TIME
TO FIT SECURITY IS
BEFORE YOU NEED IT!

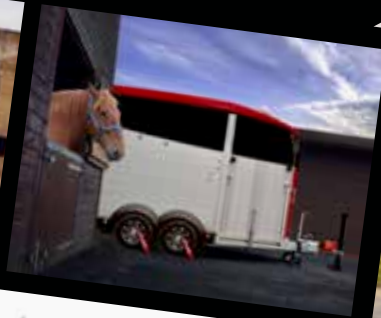

SAS SECURITY PRODUCTS LTD

PRODUCT BROCHURE 2026



NOW
INCORPORATING

PJB
SECURITY
PRODUCTS



ABOUT US

At SAS Security Products we understand how much your valuable assets mean to you – whether it's the freedom of your caravan, the convenience of your trailer, the security of your property, or the safety of your vehicles, these aren't just things; they are investments in your lifestyle, your hobbies, your livelihood.

But here's the tough truth: in the evolving landscape of today's world, the threats of crime and theft persist and continue to rise. While some crime figures show progress, specialist reports highlight ongoing challenges. Did you know that 'trailer theft made a worrying resurgence, up 15% to £1.3m*' in 2024, and rural crime remains 'increasingly organised, serious and persistent in nature*.' This constant threat underscores the critical need for robust security measures.

Our mission at SAS is simple: to help put a stop to theft by providing reliable security solutions designed to keep all your valuable assets safe and secure. We are here to help you protect your investments and give you that priceless feeling of security.

For over 38 years, we have been dedicated to designing and manufacturing some of the most trusted security products on the market. From our renowned wheel clamps and hitch locks for caravans and trailers, to robust solutions for property, vehicles, and everyday universal security needs, quality, reliability, and your peace of mind are always at the heart of everything we do.

We've spent decades listening to our customers, understanding their needs, and constantly evolving our products to stay one step ahead of criminals. That's why so many owners, insurers, and industry experts trust us to secure their world.

Secure your world with SAS Security Products and experience the confidence that comes with knowing your assets are protected.

* NFU Mutual's 2025 Rural Crime Report

"This firm has to be. Or should be the best in the UK. The staff went above and beyond to help me with my needs."

M. Smith

"Thank you for helping me purchase the correct hitch locks for our trailers. Having both locks on the same keys is going to make things so much easier!"

L. Bean

NOW
INCORPORATING

PJB
**SECURITY
PRODUCTS**

A Powerful Partnership: PJB Security Products Joins SAS

We're thrilled to announce that PJB Security Products has officially joined the SAS Security Products family. This exciting acquisition brings together two respected names in high-quality security solutions, creating an even more comprehensive range of security products.

PJB Security Products boasts a proud heritage of over thirty years, specialising in robust security for motorcycles, scooters, ATVs, Quads, bicycles, and essential garage, shed and outdoor areas. Their expertise in ground anchors, chains, and locking devices, combined with their British manufacturing excellence, perfectly complements SAS's extensive portfolio. This strategic addition means more choice for our loyal SAS customers and the same high-quality, reliable products for existing PJB customers, all under the trusted SAS brand.

CONTENTS

- Product Quality, Testing and Approval - Pages 4-5
- New Products - Pages 6-9 • Security Guides - Pages 10-13

WHEEL SECURITY

- Wheelclamp Selector Guide • The Quad Shield.
- Wheelclamps • Locking Wheel Bolts



14 - 25

TOWING HITCH SECURITY

- Hitchlock Selector Guide • Hitchlocks
- Replacement Coupling Locks • Towing Eye Locks



26 - 37

CARAVAN SECURITY

- Leg Locks



38 - 39

VEHICLE SECURITY

- Van Lock • Trailer Door Lock • Trailer Ramp Lock
- King Pin Lock • Steering Wheel Locks



40 - 45

PROPERTY SECURITY

- Garage Door Locks and Defenders
- Roller Shutter Locks • Shed Locks
- Hasp and Padlock • Security Posts



46 - 53

UNIVERSAL SECURITY

- Cable Locks • Chains and Padlocks
- Docking Stations • Ground Anchors
- Load Restraint Straps



54 - 71

ACCESSORIES & SPARE PARTS

- Care Products • Replacement Locks
- Parts and Accessories

Discover more parts online - www.sasproducts.com



72 - 75

THE SAS GREEN RANGE

- Eyelocks • Hitchlocks • Wheelclamps

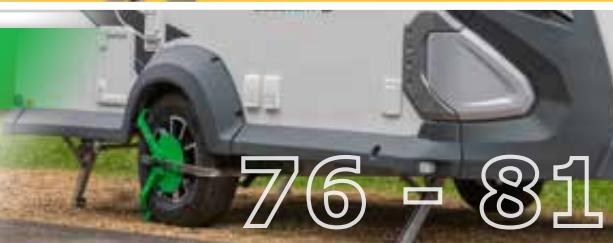

76 - 81

TESTED. TRUSTED. SECURED.

When it comes to protecting what matters most, you need security you can depend on. That's why uncompromising quality is at the heart of every product we design, ensuring that from the product body to the high-security locks, every part is engineered for superior protection. Our commitment to quality is proven by the rigorous, independent testing that many of our products undergo, allowing our solutions to stand up to everything from opportunist thieves to organized crime, giving you the ultimate peace of mind.

Security made simple

We understand that security shouldn't be a hassle. We believe in providing solutions that make your life simpler. From our quick-fitting products that are designed for fast and easy installation to our keyed alike options that allow a single key to operate multiple locks, our focus is on providing reliable security that works around you.

The Keyed-Alike advantage

For ultimate convenience, our keyed alike option allows one key to operate multiple locks. For example, if you have two or more SAS products with the same type of lock, the same key could be used to operate all the locks. This simplifies your security routine and eliminates the need to carry a large, jangling set of keys. Ask us about the keyed alike option on our qualifying products.



Sold Secure



What is Sold Secure?

Sold Secure is an independent, third-party organization that rigorously tests and certifies security products in the UK. Established by police and owned by the Master Locksmiths Association, they are the industry's benchmark for security testing. They provide reliable, unbiased information on how well a security product performs against real-world attack methods.

Why Sold Secure Matters to You

When a product carries the Sold Secure approval, it means it has been independently tested to withstand determined attacks from thieves. This isn't just a claim, it's proven performance that gives you confidence in the product. Many insurers recognise or require Sold Secure products, potentially aiding your policy or claims.

Understanding Sold Secure Ratings

Sold Secure uses a clear tiered rating system to indicate a product's level of resistance:

- **Bronze:** Good resistance against opportunist thieves.
- **Silver:** Greater resistance against more determined thieves.
- **Gold:** High resistance against dedicated thieves.
- **Diamond:** The highest security grade, designed to deter the most destructive and professional attacks.

(The higher the rating, the tougher the test a product has passed.)

Look for the Sold Secure quality mark on our approved products.

Secured by Design



SAS proudly offers solutions accredited by **Secured by Design (SBD)**. We are an Accredited Member Company of this official police security initiative, meaning products are rigorously tested to the Police Preferred Specification. When you choose an SBD-approved product, you're investing in security that is recognised and trusted by the police to deter and reduce crime. Look for the SBD quality mark on our approved products.

Insurance Approved



Many insurers recognise the robust security our products provide. While our products meet industry criteria for approval, we always recommend confirming details with your specific insurance provider. Look for the insurance approval symbol on our approved products.

SAS Commitment to Quality



Many of our products now use the Detained Disc Lock. They are an advanced evolution of disc tumbler lock technology. They use rotating brass discs instead of fragile internal springs, providing enhanced anti-pick protection and zero spring fatigue. The zinc alloy body offers superior corrosion resistance and durability, while the solid brass components are built to withstand moisture and extreme conditions.

NEW PRODUCTS

NOW
INCORPORATING

PJB

SECURITY
PRODUCTS

We're thrilled to announce that PJB Security Products has officially joined the SAS Security Products family. This exciting acquisition brings together two respected names in high-quality security solutions, creating an even more comprehensive range of security products.



PJB GROUND ANCHORS

Pages 64-67



GARAGE DEFENDER

Page 48



LOCK IT BIKE ANCHOR

Page 66



DOUBLE BRIDGE ANCHOR

Page 67





SHED SECURITY HASP & FIXING KIT

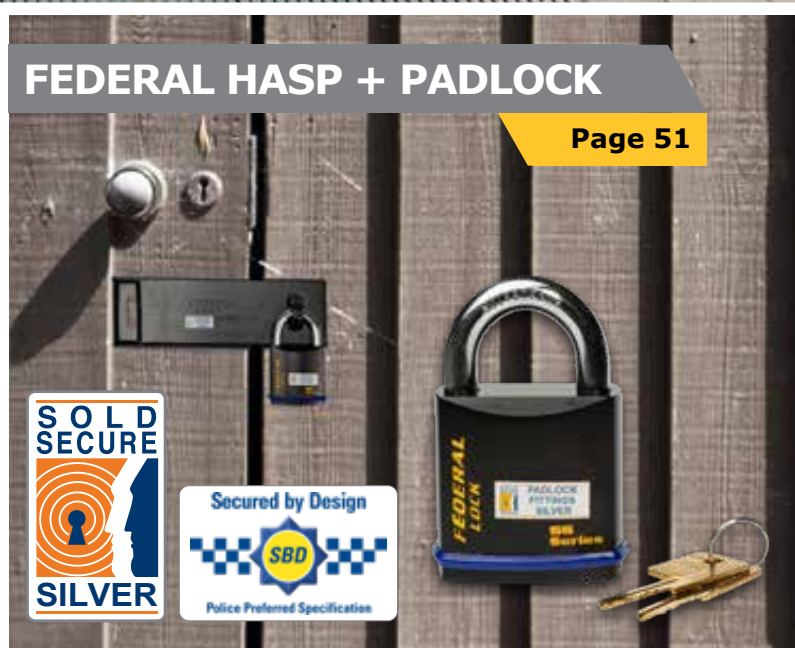

FEDERAL HASP + PADLOCK



GARAGE/SHED LOCKING BOLTS



HOOK WALL ANCHOR

AKS GREEN HITCHLOCK

Page 77



COMBI STEERING WHEEL LOCK

Page 45

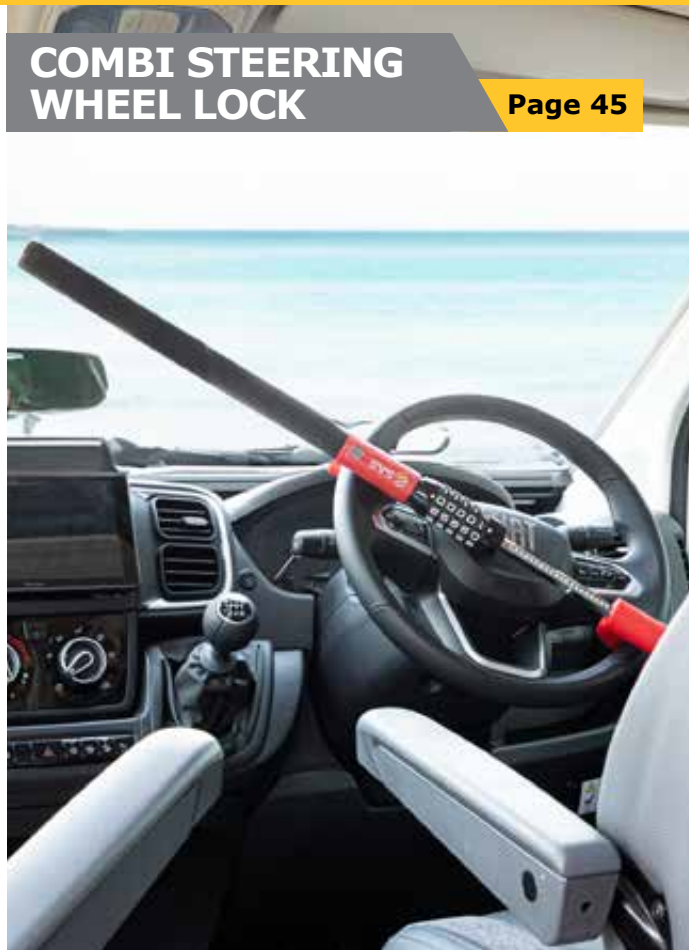

TRAILER RAMP LOCK

Page 43



FORT 30 GOLD

Page 32



NEW IMPROVED DESIGN

- FIT IN LESS THAN 15 SECONDS!
- SIMPLE PUSH TO LOCK
- EVEN STRONGER THAN BEFORE



QUAD SHIELD XL

Page 16



NEW LARGER DESIGN



FORT 35 GOLD

Page 32

NEW wider version of the FORT 30 to fit the AKS 3504 hitch

TRAILER SECURITY

The threat of theft is a major concern for every property owner. While a single security device can deter the opportunist thief, combating a more organised, professional gang that uses specialised tools and techniques requires a comprehensive security approach.

We offer a complete range of security solutions designed to protect your assets from multiple angles, ensuring maximum deterrence and providing ultimate peace of mind. This multi-layered approach is not just a theory; it's a proven strategy.

Many of our security products are rigorously tested and independently verified with accreditations like **Sold Secure** and **Secured by Design** to guarantee their effectiveness. By implementing a system that includes these highly-rated products, you not only make your property a difficult target but may also be rewarded with policy discounts from many insurance companies.

Ultimately, a multi-layered security system is your best defence, forcing thieves to abandon their efforts and seek an easier target.

TRAILER DOOR LOCK
- see page 42

SECURITY POSTS
- see pages 52-53

LOCKING WHEEL BOLTS
- see page 25

WHEELCLAMPS
- see pages 18-24

CHAIN & PADLOCKS
- see pages 56-57

GROUND ANCHORS
- see pages 64-69

HITCHLOCKS
- see pages 26-37

CARAVAN SECURITY

SECURE YOUR BIKE ON THE RACK
Steel cable locks - see pages 55



WHEELCLAMPS
- see pages 18-24

LOCKING WHEEL BOLTS
- see page 25

SECURITY POSTS
- see pages 52-53



LEG LOCKS
- see page 39

**GROUND ANCHORS,
CHAINS & PADLOCKS**
- see pages 56-69

HITCHLOCKS
- see pages 26-37

SECURITY GUIDE

PROPERTY SECURITY

**MOTORBIKE &
BICYCLE SECURITY**
- see pages 56-69

GATE LOCKS
- see page 50

GARAGE DOOR LOCKS
- see pages 47-49

SECURITY POSTS
- see pages 52-53

**GROUND ANCHORS,
CHAINS & PADLOCKS**
- see pages 56-69

PADLOCKS
- see page 58-63

**SHED LOCKS,
HASPS & PADLOCKS**
- see page 50-51

ATV/UTV SECURITY

**STOP THEFT BEFORE
IT STARTS, MAKE
THIEVES WALK ON BY**



**GROUND ANCHORS,
CHAINS & PADLOCKS**
- see pages 56-69

WHEELCLAMPS
- see pages 15-19



WHEEL SECURITY

We offer a well-trying, tested, and versatile range of wheel locking devices. We believe that a one-size-fits-all approach is not the answer to maximum theft protection, so we have engineered a variety of solutions to suit your specific wheel security requirements.

14 - 25

14-24	WHEELCLAMPS
16-17	QUAD BIKE WHEELCLAMP
25	LOCKING WHEEL BOLTS



**FOR THE ONLINE
WHEELCLAMP
SELECTOR GUIDE**

Scan the QR Code or visit
[www.sasproducts.com/
wheel-clamp-finder](http://www.sasproducts.com/wheel-clamp-finder)

Green Range Wheel Clamps
- see pages 80-81



WHEELCLAMP SELECTOR GUIDE

Wheel Dimensions:

Use our handy selection guide to find the best clamps for your wheels.

Technical Support

Our technical team will be pleased to assist you to choose the correct wheelclamp. Simply send pictures of your wheel, together with tyre sizes, for a free assessment and recommendation either by email to sales@sasproducts.com or WhatsApp to **+44 1444 675889**



Product Code	Model	Steel Wheels	Alloy Wheels	B Approx. Rim Diameter (Guide Only)	C Tyre Width (Critical Dimension)	D Wheel Bolt to Circumference (Critical Dimension)	See Page
1110101	SUPACLAMP DUO Wheelclamp	✓	✓	10-15"	160-225mm	Max 270mm	21
1120121	SUPACLAMP DUO SILVER Wheelclamp	✓	✓	10-15"	160-225mm	Max 270mm	21
1130171	SUPACLAMP DUO GOLD Wheelclamp	✓	✓	10-15"	160-225mm	Max 270mm	21
1211101	HD1 Wheelclamp*	✓		10-15"	110-195mm	Max 280mm	23
1221701	HD2 Wheelclamp*	✓		10-15"	165-225mm	Max 280mm	23
1231701	HD3 Wheelclamp	✓		12-16"	165-225mm	Max 305mm	23
1232701	HD3L Wheelclamp	✓		12-16"	200-300mm	Max 305mm	23
1241701	HD4 Wheelclamp*	✓		10" Flotation	165-215mm	Max 275mm	23
1310101	TRAILER CLAMP Wheelclamp	✓		8"/10"/12" ONLY	max 135mm	n/a	24

*Bolt/Nut cover extension pieces are available for the HD range (excluding HD3 and HD3L), where you have offset or centralised rims – See page 23 (HD4 supplied with extension piece as standard)

Product Code	New Defender Wheelclamp Model	Steel Wheels	Alloy Wheels	A Wheel Diameter Range (Critical Dimension)	C Tyre Width (Critical Dimension)	See Page
1410173	NEW DEFENDER Wheelclamp	✓	✓	490-700mm	170-275mm	19
1450773	NEW DEFENDER LARGE Wheelclamp	✓	✓	600-830mm	195-295mm	19
1470773	NEW DEFENDER XXL Wheelclamp	✓	✓	720-890mm	225-330mm	19

Product Code	ATV/UTV Wheelclamp Model	Steel Wheels	Alloy Wheels	A Wheel Diameter Range (Critical Dimension)	C Tyre Width (Critical Dimension)	See Page
1730081	QUAD SHIELD Wheelclamp	✓	✓	24"-27" (610-685mm)	up to 10.5" (260mm)	17
1760081	QUAD SHIELD XL Wheelclamp	✓	✓	28-31" (710-785mm)	up to 11.5" (285mm)	17

These tables are intended as a guide only for selecting a suitable wheelclamp, but due to there being so many different tyres and rim configurations, we cannot be held responsible for any inconvenience should it not fit your wheel.

WHEELCLAMPS

THE QUAD SHIELD

The Quad Shield is a robust, drive-in ground anchor and clamp system that has been awarded the Sold Secure Diamond rating—the highest level of protection available. Now also in a new XL size, this product provides professional-grade, independently verified security.



QUAD SHIELD



QUAD SHIELD XL

**TOUGH SECURITY.
TOUGHER CHOICE
FOR THIEVES**



- › Simply drive your ATV or UTV into the clamp system, pull lever to enclose top of wheel and push locks to secure
- › Unique design fully protects against driving out or removal by tyre deflation
- › Double locking system, simple push to lock, with key only required to unlock
- › High security anti-pick, anti-drill, steel encased locks
- › Fixing bolts supplied to secure the clamp to concrete floor and easy to move
- › Excellent visual and physical deterrent



**SCAN FOR
DEMO VIDEO**



The *ULTIMATE* theft deterrent!



Dual anti-pick & anti-drill locks



Drive-in and lock



🔑 1200 quad bikes and ATVs (all-terrain vehicles) are stolen every year in the UK and theft rates continue to rise every year 🚔

Secured by Design (SBD) 2025

Product Code	Model	Alloy Wheels	Steel Wheels	Tyre Diameter	Tyre Width
1730081	QUAD SHIELD Wheelclamp	✓	✓	24"-27" (610-685mm)	up to 10.5" (260mm)
1730082	QUAD SHIELD Wheelclamp - Keyed Alike				
1760081	QUAD SHIELD XL Wheelclamp				
1760082	QUAD SHIELD XL Wheelclamp - Keyed Alike			28-31" (710-785mm)	up to 11.5" (285mm)

Ground Anchors - see pages 64-60
Heavy Duty Chains - see pages 56-57

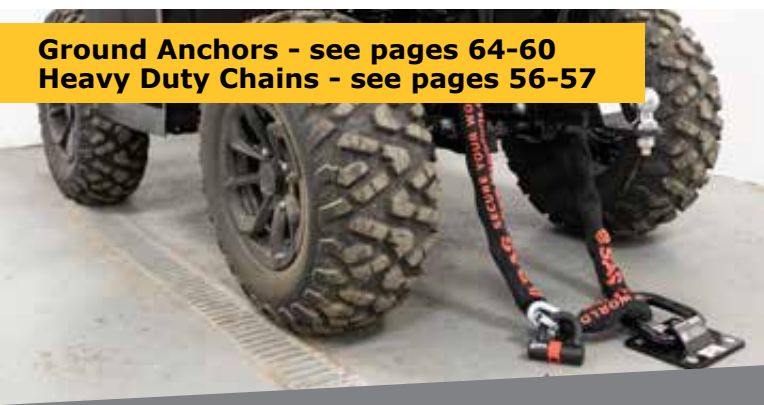

WHEELCLAMPS

THE NEW DEFENDER RANGE

For those who take security seriously, the New Defender will give you a versatile clamp that won't be beaten easily. The three sizes available cover a vast range of vehicles, including large off-road vehicles.



NEW DEFENDER



NEW DEFENDER LARGE



NEW DEFENDER XXL

- › Unique design fully protects against driving out or removal by tyre deflation
- › High security anti-pick, anti-drill, steel encased lock
- › Fits over wheel trims on steel or alloy wheels
- › Adjustable arms fit around wheel and lock securely
- › Excellent visual and physical deterrent
- › New Defender is supplied in a durable plastic carry case
- › New Defender Large and XXL are supplied in a cardboard box
- › Sold Secure Gold tested and approved for caravans and automotive



“Here is a wheel clamp that will definitely not surrender to bolt cutters or hacksaw– no way... it is really thief resistant and tough.”

John Marchmont, Caravanners Handbook





New Defender Large



New Defender XXL

Good effective design, solid and well made, denies access to wheel nuts, a good visual deterrent, easy to fit at a reasonable price.

Camping and Caravan Magazine



Product Code	Model	Alloy Wheels	Steel Wheels	Min-Max Wheel Diameter	Tyre Width
1410173	NEW DEFENDER Wheelclamp	✓	✓	19-28"	7-11"
1410174	NEW DEFENDER Wheelclamp, Keyed Alike	✓	✓	(490-700mm)	(170-275mm)
1450773	NEW DEFENDER LARGE Wheelclamp	✓	✓	24-33"	8-12"
1450774	NEW DEFENDER LARGE Wheelclamp, Keyed Alike	✓	✓	(600-830mm)	(195-295mm)
1470773	NEW DEFENDER XXL Wheelclamp	✓	✓	29-35"	9-13"
1470774	NEW DEFENDER XXL Wheelclamp, Keyed Alike	✓	✓	(720-890mm)	(225-330mm)

Replacement locks and spares – see pages 73-74

CARAVAN & TRAILER WHEELCLAMPS

SUPACLAMP DUO RANGE

The Supaclamp Duo range is a versatile range designed to fit both Alloy and Steel wheels, very popular with many discerning caravan and horse box owners.



- › Designed to fit 10"-15" alloy or steel wheels, 160-225mm width
- › One-piece clamp, fitting snugly into one wheel bolt hole on alloy wheel and fits easily around wheel and locks securely
- › High security steel encased lock
- › Double locking for extra security
- › Quick and easy to fit
- › Excellent visual and physical deterrent
- › Supplied in durable plastic carry case for easy storage and transportation



SUPACLAMP DUO

- › Strong and popular clamp
- › Multiple clamps can be ordered with locks on the same key



SUPACLAMP DUO

SILVER



- › Reinforced front arm for extra security
- › Shorter reinforced and hardened rear clamp arm for fitting to Ifor Williams horse boxes and trailers with leaf springs
- › Sold Secure Silver rated for caravans and trailers



SUPACLAMP DUO

GOLD



- › Reinforced front arm for extra security
- › Reinforced and hardened rear clamp arm
- › High security anti-pick and anti-drill lock barrel
- › Sold Secure Gold rated for caravans and trailers



Product Code	Model	Alloy Wheels	Steel Wheels	Wheel Size	Tyre Width
1110101	SUPACLAMP DUO Wheelclamp	✓	✓	10-15"	160-225mm
1110102	SUPACLAMP DUO Wheelclamp, Keyed Alike				
1120121	SUPACLAMP DUO SILVER Wheelclamp	✓	✓	10-15"	160-225mm
1120122	SUPACLAMP DUO SILVER Wheelclamp, Keyed Alike				
1130171	SUPACLAMP DUO GOLD Wheelclamp	✓	✓	10-15"	160-225mm
1130172	SUPACLAMP DUO GOLD Wheelclamp, Keyed Alike				

Replacement locks and spares - see pages 73-74

CARAVAN & TRAILER WHEELCLAMPS

THE ORIGINAL HD RANGE

The Original heavy-duty range is a favourite for steel rim wheels that has stood the test of time. Whether it's for your trailer or caravan, you can rest assured, knowing this easy to fit clamp will keep your investment safe.



- › Range of models to suit many different steel wheels 10"-16", 80-300mm width
- › One-piece clamp, covers one wheel nut and fits easily around wheel and locks securely
- › High security steel encased lock
- › Double locking for maximum security
- › Quick and easy to fit
- › Excellent visual and physical deterrent
- › HD1 only is supplied in durable plastic carry case for easy storage and transportation
- › Extension tubes available for deep set wheel bolts (supplied as standard with HD4)
- › Multiple clamps can be ordered with locks on the same key across the HD range



HD1 is supplied with a durable carry case. (HD2, HD3 and HD4 are supplied in a printed cardboard box)





Product Code	Model	Steel Wheels	Wheel Size	Tyre Width
1211101	HD1 Wheelclamp	✓	10-15"	110-195mm
1211102	HD1 Wheelclamp, Keyed Alike			
1221701	HD2 Wheelclamp	✓	10-15"	165-225mm
1221702	HD2 Wheelclamp, Keyed Alike			
1231701	HD3 Wheelclamp	✓	12-16"	165-225mm
1231702	HD3 Wheelclamp, Keyed Alike			
1232701	HD3L Wheelclamp	✓	12-16"	200-300mm
1232702	HD3L Wheelclamp, Keyed Alike			
1241701	HD4 Wheelclamp	✓	20.5x8-10 or 205/65D10	
1241702	HD4 Wheelclamp, Keyed Alike		extension tube included	
9120050	Extension Tube, straight 1" (25mm)		suitable for HD1 & HD2	
9120063	Extension Tube, straight 1.5" (37mm)		suitable for HD1 & HD2	
9120075	Extension Tube, straight 2" (50mm)		suitable for HD1 & HD2	

Replacement locks and spares – see pages 73-74

CARAVAN & TRAILER WHEELCLAMPS



THE TRAILER CLAMP

The Trailer Clamp is ideal for trailer tents, camping and jet-ski trailers, as well as general purpose domestic trailers. An incredibly strong clamp for those who value quality, want ease of use and peace of mind!

- › Fits 8", 10" and 12" central dished trailer wheels
- › Secure dome covers all 4 wheel nuts/ bolts (150mm dia x 75mm depth)
- › High security steel encased lock
- › Double locking for maximum security
- › Quick and easy to fit
- › Excellent visual and physical deterrent
- › Supplied in durable plastic carry case for easy transportation



› Multiple clamps can be ordered with locks on the same key



Product Code	Model	Steel Wheels	Wheel Size
1310101	TRAILER CLAMP Wheelclamp	✓	8"-10"-12" centrally dished
1310102	TRAILER CLAMP Wheelclamp, Keyed Alike		

Replacement locks and spares – see pages 73-74

LOCKING WHEEL BOLTS

LOCKING WHEEL BOLTS

Locking wheel bolts, as used on most cars, are an excellent way to hinder wheel theft.

The SAS locking wheel bolts will fit both alloy and steel wheels on most caravans and trailers. SAS offers two levels of security, with the premium set giving you that extra reassurance.

- › Option of 2, 4 or 6 bolts in set, for single, twin and triple axle trailers/caravans
- › Suitable for steel and alloy wheels with two different seat types
- › Supplied in storage case, complete with unique matching key



Product Code	Set Quantity	Model	Seat Type	Thread
1812187	2	Locking Wheel Bolts	Conical	M12x1.5mm
1814187	4			
1832189	2	Premium Locking Wheel Bolts	Conical	M12x1.5mm
1834189	4			
1836189	6			
1834289	4	Premium Locking Wheel Bolts	Conical	M14x1.5mm
1836289	6			
1852189	2	Premium Locking Wheel Bolts	Spherical	M12x1.5mm
1854189	4			
1856189	6			
9188701	Replacement key only for 181 Locking Wheel Bolts			
9188901	Replacement key only for 183 & 185 Premium Locking Wheel Bolts			

SEAT TYPES



Conical



Spherical



Locking Wheel Bolts



Premium Locking Wheel Bolts

TOWING HITCH SECURITY

Our hitchlocks provide a powerful defence against caravan or trailer theft. Many will fit both hitched and unhitched, which will certainly deter those motorway service thieves! There are many hitch types available, but we are confident that you will find the perfect fit for your application.

26 - 37

27-29	HITCHLOCK SELECTOR GUIDES
30-34	HITCHLOCKS
35	REPLACEMENT COUPLING LOCKS
36-37	TOWING EYE LOCKS



**FOR THE LATEST HITCHLOCK
SELECTOR GUIDE**

Scan the QR Code or visit
[www.sasproducts.com/
hitch-lock-finder](http://www.sasproducts.com/hitch-lock-finder)



Universal Green Range Hitchlocks
- see pages 76-79



HITCHLOCK SELECTOR GUIDE

Why fit a hitchlock to my trailer or caravan?

SAS hitchlocks are an essential item for anyone with a trailer or caravan, as they are so easy to steal if they are not locked – just hitch up and go! The SAS hitchlock range comprises of various easy to fit options to give you that peace of mind that someone else can't easily hook up to their vehicle and drive off.

Many hitchlocks in the SAS range offer you the option to lock your caravan or trailer to the towing vehicle when parked in the motorway services. Or, if you are a landscape gardener or tree surgeon, you may wish to lock your trailer or woodchipper to your truck whilst working in the back garden.

Does your trailer have a ball hitch or an eye hitch?

Ball Style Hitch

50mm ball hitch is the most common for trailers and on virtually all caravans

Eye Hitch



If YES
Go to pages
36-37

Does your trailer/caravan have brakes?

Braked trailers will generally have a rubber bellow directly behind the hitch, then a braking damper device mounted on the drawbar frame.



If YES
Go to page
29

No

Is your trailer an unbraked version?

Where the hitch is mounted directly to a fixed drawbar on the trailer.



If YES
Go to page
28

Unsure?

Technical Support

Our technical team will be pleased to assist you to choose the correct hitchlock. Simply send pictures of your hitch coupling for a free assessment and recommendation, either by

email to sales@sasproducts.com or WhatsApp to +44 1444 675889

HITCHLOCK SELECTOR GUIDE

HITCHLOCKS FOR UNBRAKED TRAILERS

Where the hitch is mounted directly to a fixed drawbar on the trailer.

In addition to multiple different hitch heads being used on trailers, manufacturers also use a vast range of different drawbars and fixing methods on unbraked trailers. SAS are always seeking to develop and adapt hitchlocks to cater for as many as possible. Below is a guide to help identify the right hitchlock for your trailer.

Pressed Steel Hitch

There are many different versions, from various manufacturers, but they are typically have the folded rim around the bottom, being pressed from a sheet of steel. The metal is normally zinc plated and a relatively smooth finish.



Bradley Cast Hitch

Cast hitch heads are thicker material and a slightly rough surface to touch.



Indespension Triple Lock



Bradley Double Lock (D Handle)



Knott Cast Hitch



Y-Shaped Coupling on A-Frame Drawbar



Drawbar must have an angled rear shape coupling as shown in picture above.

Straight Drawbar



A-Frame to Straight Drawbar



A-Frame Drawbar with straight coupling

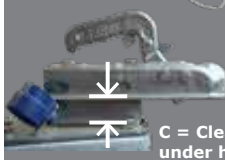

C = Greater than 25mm

C = Less than 25mm

Straight Drawbar



A-Frame to Straight Drawbar



A-Frame Drawbar



Straight Drawbar



A-Frame to Straight Drawbar



A-Frame Drawbar



ORIGINAL HL3 hitchlock

2330751



ORIGINAL HL2 HITCHLOCK

2320751



FORT U HITCHLOCK

2180761



FORT TU HITCHLOCK

2190761



Most unbraked trailers are fitted with a breakaway safety cable. Sometimes these cables are fitted to small metal brackets and these brackets can obstruct the fitting of the hitchlocks. In this situation, seek advice from your trailer specialist as they will likely be able to adapt these slightly to allow fitting.

These tables are intended as a guide only for selecting a suitable hitchlock, but due to there being so many variants on trailer hitches and drawbars, SAS cannot be held responsible should it not fit your hitch.

Replacement Barrel Locks
- see pages 35



See Hitch Padlocks
- page 34



See Universal Green Range - pages 76-79



HITCHLOCKS FOR BRAKED TRAILERS & CARAVANS

Braked trailers will generally have a rubber bellow directly behind the hitch, then a braking damper device mounted on the drawbar frame.



	Hitch Manufacturer	Hitch Model	SAS hitchlocks						
			2120761 FORT A	2140761 FORT AK	2130761 FORT B	2160761 FORT K	2170761 FORT T	2230781 FORT 30 GOLD	2350781 FORT 35 GOLD
A1	ALBE	Cast Hitch	●			● *			
B1	ALBE	Pressed Steel Hitch				●			
C1	AL-KO	AK160, AK180, AK300				●		●	
D1	AL-KO	AK161, AK270, AK251s	●			● *			
E1	AL-KO	AK350 Cast Hitch	●						
F1	AL-KO	AK301		●	●				
	AL-KO	AK351	●	●					
G1	AL-KO	AKS1300						●	
H1	AL-KO	AKS2004						●	
J1	AL-KO	AKS3004						●	
	AL-KO	AKS3504							●
K1	BRADLEY	Autohead 2.7 & 3.5kg			●				
L1	BRADLEY	Double Lock					●		
L2	INDESPENSION	Triplelock					●		
L5	KARTT	KCH3000 Cast Hitch				●			
M1	KNOTT	Avonride Cast Hitch	●						
N1	KNOTT	Pressed Steel Hitch				●			
O1	KNOTT	K27 & K35 Cast Hitch	●						
O2	KNOTT	Cast Hitch	●						
O6	SPP	Pressed Steel Hitch				●			
O7	SPP	Cast Hitch				●			
P1	WINTERHOFF	WW8				●			
Q1	WINTERHOFF	WW13				●			
R1	WINTERHOFF	WW30 Cast Hitch	●			● *			
S1	WINTERHOFF	WW200 Cast Hitch	●						

* If the hitch has a vertical fixing bolt use the FORT A hitchlock instead.

● Recommended

● Alternative

HITCHLOCKS

FORT RANGE

The FORT hitchlock series covers a wide range of trailer couplings on the market.



- › Can be fitted whilst caravan/trailer is hitched or unhitched from towing vehicle
- › Prevents vehicle and caravan/trailer being separated in a car park or motorway service station
- › Quick and easy to fit, strong twin wall steel structure fully encloses hitch and bolts to provide maximum protection against attack
- › Maximum security safe-style enclosed lock, with twin locking pins and anti-drill protection
- › Secure cruciform style keys
- › Excellent visual and physical deterrent
- › Compact and easily stored – ideal for touring



Use our hitchlock selector guide to select the correct lock for your hitch - see pages 27-29





FORT U

Hitchlock securing trailer to security post - see pages 52-53

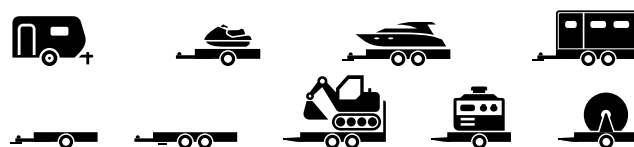

A neat, immensely strong and impressive hitchlock. Dinghy Sailing Magazine



Product Code	Model	Secure Unhitched	Secure Hitched*
2120761	FORT A hitchlock	✓	✓
2120762	FORT A hitchlock - Keyed Alike		
2140761	FORT AK hitchlock	✓	✓
2140762	FORT AK hitchlock - Keyed Alike		
2130761	FORT B hitchlock	✓	✓
2130762	FORT B hitchlock - Keyed Alike		
2160761	FORT K hitchlock	✓	✓
2160762	FORT K hitchlock - Keyed Alike		
2170761	FORT T hitchlock	✓	✓
2170762	FORT T hitchlock - Keyed Alike		
2190761	FORT TU hitchlock	✓	✓
2190762	FORT TU hitchlock - Keyed Alike		
2180761	FORT U hitchlock	✓	✓
2180762	FORT U hitchlock - Keyed Alike		

* The police do not like your caravan or trailer to be locked to the vehicle whilst travelling, as it makes it difficult to separate in the case of an accident.

Replacement locks - see pages 73-74

HITCHLOCKS

FORT 30 GOLD HITCHLOCK

The FORT 30 GOLD and FORT 35 GOLD hitchlocks are Sold Secure Gold rated, making them a highly popular choice for proven caravan security. The FORT 30 GOLD is engineered to fit the widely used AL-KO stabiliser coupling heads, while the slightly larger FORT 35 GOLD is designed specifically to secure the AL-KO AKS3504.



“A worthy product.”
Caravan Buyer Magazine

Product Code	Model	Secure Unhitched	Secure Hitched*
2230781	FORT 30 GOLD hitchlock	✓	✓
2230782	FORT 30 GOLD hitchlock -Keyed Alike		
2250781	FORT 35 GOLD hitchlock	✓	✓
2250782	FORT 35 GOLD hitchlock -Keyed Alike		
9220021	Replacement black ABS towball		

Replacement locks - see page 73

* The police do not like your caravan or trailer to be locked to the vehicle whilst travelling, as it makes it difficult to separate in the case of an accident.



NEW

IMPROVED DESIGN

- FIT IN LESS THAN 15 SECONDS!
- SIMPLE PUSH TO LOCK
- EVEN STRONGER THAN BEFORE

- › Can be fitted to a caravan/trailer to secure hitched* or unhitched from towing vehicle
- › Prevents vehicle and caravan/ trailer being separated in a car park or motorway service station
- › FORT 30 Gold - Fits 1300, 2004, 3004 AL-KO stabilising heads and standard AL-KO hitch heads
- › FORT 35 Gold - Fits 3504 AL-KO hitch
- › Fully encloses hitch handle and bolts
- › High security steel encased lock
- › Quick and easy to fit
- › Excellent visual and physical deterrent



THE ORIGINAL SAS HITCHLOCKS

The Original hitchlock range is designed to fit a range of pressed steel hitches on both braked and unbraked trailers.



HL2 HITCHLOCK



HL3 HITCHLOCK





The HL2 is a robust hitchlock designed primarily for unbraked trailers with a drawbar up to 60mm wide. Its design accommodates virtually any drawbar depth, making it a highly versatile security solution. It will also fit many trailers that have a rest stand fitted underneath the hitch, securing it in place using the hitch's existing bolts.

The HL3 hitchlock is engineered specifically for unbraked trailers with A-Frame drawbars that are fitted with a Y-shaped coupling hitch. Its dedicated design ensures a secure and precise fit, providing reliable protection for this common type of trailer.

Use our hitchlock selector guide, on pages 27-29 to choose the correct lock for your hitch

- › Can be fitted whilst caravan/trailer is hitched or unhitched from towing vehicle
- › Prevents vehicle and caravan/trailer being separated in a car park or motorway service station, when stationary
- › Quick and easy to fit, strong steel structure fully encloses hitch and bolts
- › Fitted with high security anti-drill radial pin tumbler lock
- › Excellent visual and physical deterrent
- › Compact and easily stored – ideal for touring

 **Voted best buy for its security and value.** 

Caravan Life



Product Code	Model	Secure Unhitched	Secure Hitched*	Fits
2320751	HL2 Original hitchlock	✓	✓	See Selection Guide on pages 27-29
2320752	HL2 Original hitchlock, Keyed Alike			
2330751	HL3 Original hitchlock	✓	✓	
2330752	HL3 Original hitchlock, Keyed Alike			

Replacement locks - see page 73

HITCHLOCKS

KB21 UNILOCK

This special purpose shackle lock is the quick and easy way to secure Knott pressed steel hitches that feature a curved handle with a hole right through, providing fast, reliable protection for your trailer.



- › Solid brass lock body, giving great durability.
- › Enclosed hardened chrome plated steel shackle, for increased strength.
- › High precision 6 pin brass lock and cylinder core, for a smooth operation
- › Supplied with 3 nickel plated brass keys.
- › Also available Keyed Alike.

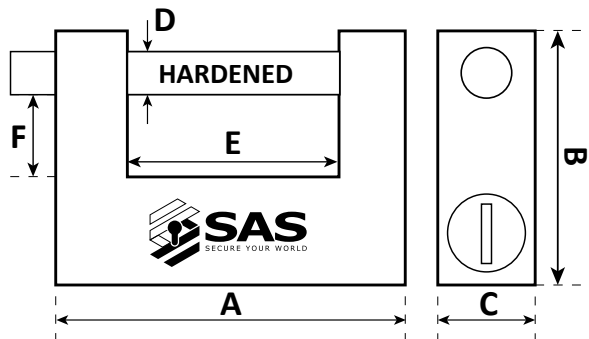

Blue Line box trailer rear shutter door or ramp catches



Ifor Williams trailer rear door/ramp

Product Code	Model	A	B	C	D	E	F
8300021	KB21 UNILOCK	80	55	18	7	42	19.9
8300022	KB21 UNILOCK, Keyed Alike						

Dimensions shown are an approximate maximum (mm)

REPLACEMENT LOCKS FOR HITCH COUPLINGS

For proven security and convenience, our range of replacement integral locks provide a direct solution for popular hitches. These robust locks are designed to easily replace your old, broken, or non-functioning lock, ensuring your hitch remains secure.



Product Code	Model	Keys Supplied
9003313	SAS ULTIMATE barrel lock for Bradley Auto & Doublelock hitch heads	3
9003413	SAS ULTIMATE barrel lock for Bradley Auto & Doublelock hitch heads, Keyed Alike	3
9004712	Replacement barrel lock for AL-KO AK301 & AK351 hitch heads	2
9005712	Replacement barrel lock for Knott Avonride hitch heads	2





Trailer Door Lock
- see page 42



Trailer Ramp Lock
- see page 43

HITCHLOCKS

HD BOX EYELOCK

The SAS HD Box Eyelock is a robust, heavy-duty box eye lock constructed to prohibit unbolting the towing eye hitch from the draw bar.

Made of a strong 5mm thick steel box section, making it virtually indestructible, and is a popular product not only for utility contractors to secure their plant trailers, but also fitting many hauliers drag-type truck trailers, towable agricultural equipment and trailers. One size fits most towing eyes.



EL50XL



HD BOX EYELOCK



HEAVY DUTY
BOX EYELOCK

**NEW
IMPROVED**

**NOW FULLY
ENCLOSED
DESIGN**

- › Robust heavy-duty box eyelock, constructed to prohibit unbolting the towing eye hitch from the drawbar
- › High security steel encased lock
- › Quick and easy to fit
- › Excellent visual and physical deterrent
- › Can be keyed alike for fleets
- › Strong 5mm thick steel casing



MAX 139mm wide



**Wheelclamps
- see pages 18-24**

TOWING EYELOCKS

Towing eye hitches are most commonly used for the heavier trailers, such as generator, compressor, plant and farm machinery trailers.

SAS eyelocks are constructed from thick steel, making them virtually indestructible, and clearly an industry leading product.

Heavy construction includes:-



6mm Plate Steel

10mm Plate Steel



EL3040



EL50



EL50XL



- › Three versions available to fit 30, 40 and 50mm towing eyes
- › Fully encloses eye
- › Premium security steel encased lock
- › Quick and easy to fit
- › Excellent visual and physical deterrent
- › Multiple eye locks can be ordered with locks on the same key



Product Code	Model	Secure Unhitched	Secure Hitched	Fits	Maximum Eye Dimensions	
					w	h
2711721	HD BOX EYELOCK	✓	✗	Most Towing Eye Hitches	137mm	108mm
2711722	HD BOX EYELOCK, Keyed Alike	✓	✗			
2731721	EL3040 EYELOCK	✓	✗	30 & 40mm Towing Eye Hitches	100mm	32mm
2731722	EL3040 EYELOCK, Keyed Alike	✓	✗			
2751721	EL50 EYELOCK	✓	✗	50mm Towing Eye Hitches	113mm	39mm
2751722	EL50 EYELOCK, Keyed Alike	✓	✗			
2761721	EL50XL EYELOCK	✓	✗	50mm Towing Eye Hitches	124mm	49mm
2761722	EL50XL EYELOCK, Keyed Alike	✓	✗			

Replacement locks - see page 73

CARAVAN SECURITY

We understand how important it is to secure your caravan and the lifetime of memories you've created. Our wheel clamps and hitchlocks should be an essential part of your security solution, but we can offer even more layers of security to safeguard your most valuable assets.

38 - 39

39

LEG LOCKS

EVERY SECURITY LAYER
ADDS STRENGTH



Locking Wheel Bolts
- see page 25

Wheelclamps
- see pages 18-24

Leg Locks
- see page 39

Ground Anchors,
Chains & Padlocks
- see pages 54-69

Hitchlocks
- see pages 26-34

Security Posts
- see pages 52-53

HEAVY-DUTY LEG LOCKS

The seemingly small and insignificant leg locks are often forgotten, but many have proved their value. Lock your corner steadies in the down position and your caravan becomes very difficult to tow away!



Another barrier to delay the time conscious thieves, these simple to fit devices are worth the modest premium.

Caravan Buyer Magazine



- Available as twin or quad packs
- Packs are keyed alike, and supplied in a handy storage case
- Double locking system – need key and Hex key
- Strong anti-crush steel construction hinders removal
- Designed to fit 19mm hex winders, where you have access to the corner steady nuts, not shielded by the caravan body
- Quick and easy to fit
- Excellent visual and physical deterrent
- Each leg lock supplied with two keys, multiple sets have matching keys
- Each set supplied complete with Allen key and Hex key too.

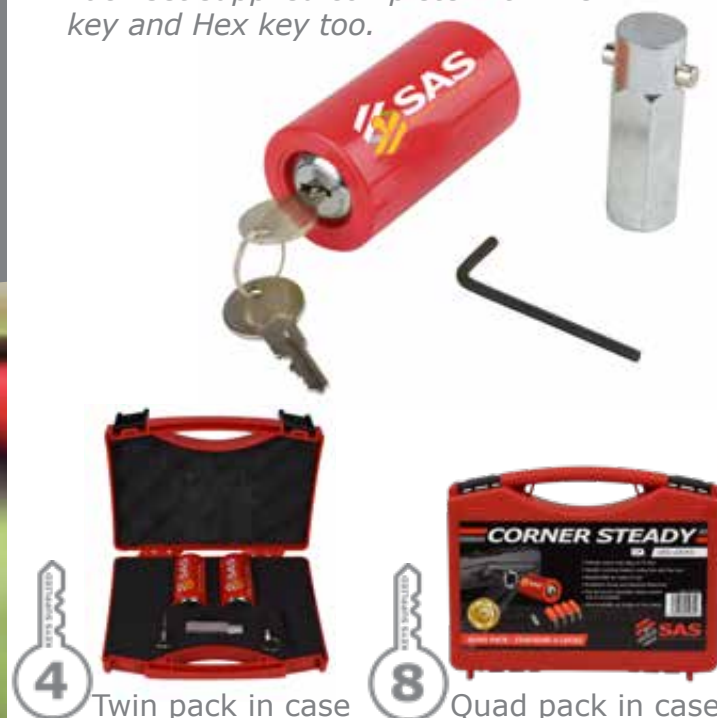

Product Code	Model	Case Supplied
3120141	HDLL2, Heavy-Duty Leg Lock, Twin Pack, Keyed Alike	✓
3140141	HDLL4, Heavy-Duty Leg Lock, Quad Pack, Keyed Alike	✓
Spare Parts		
9310034	Allen key	
9310036	Metal inner casing tube only	
9310037	Hex key	
9319935	Outer casing tube only (without lock)	
9004112	Lock with 2 keys	
9300012	Case only for twin pack	
9300014	Case only for quad pack	

VEHICLE SECURITY

With vehicle theft on the rise, we offer many proven security solutions to protect your car, van, or entire fleet. In a world of increasing keyless vehicle and electronic theft, our heavy duty, robust devices provide maximum physical protection from the traditional to the tech savvy thief!

40 - 45

- 41 VAN DOOR LOCK
- 42 TRAILER DOOR LOCKS
- 43 TRAILER RAMP LOCK
- 44 KINGPIN LOCK
- 45 STEERING WHEEL LOCKS

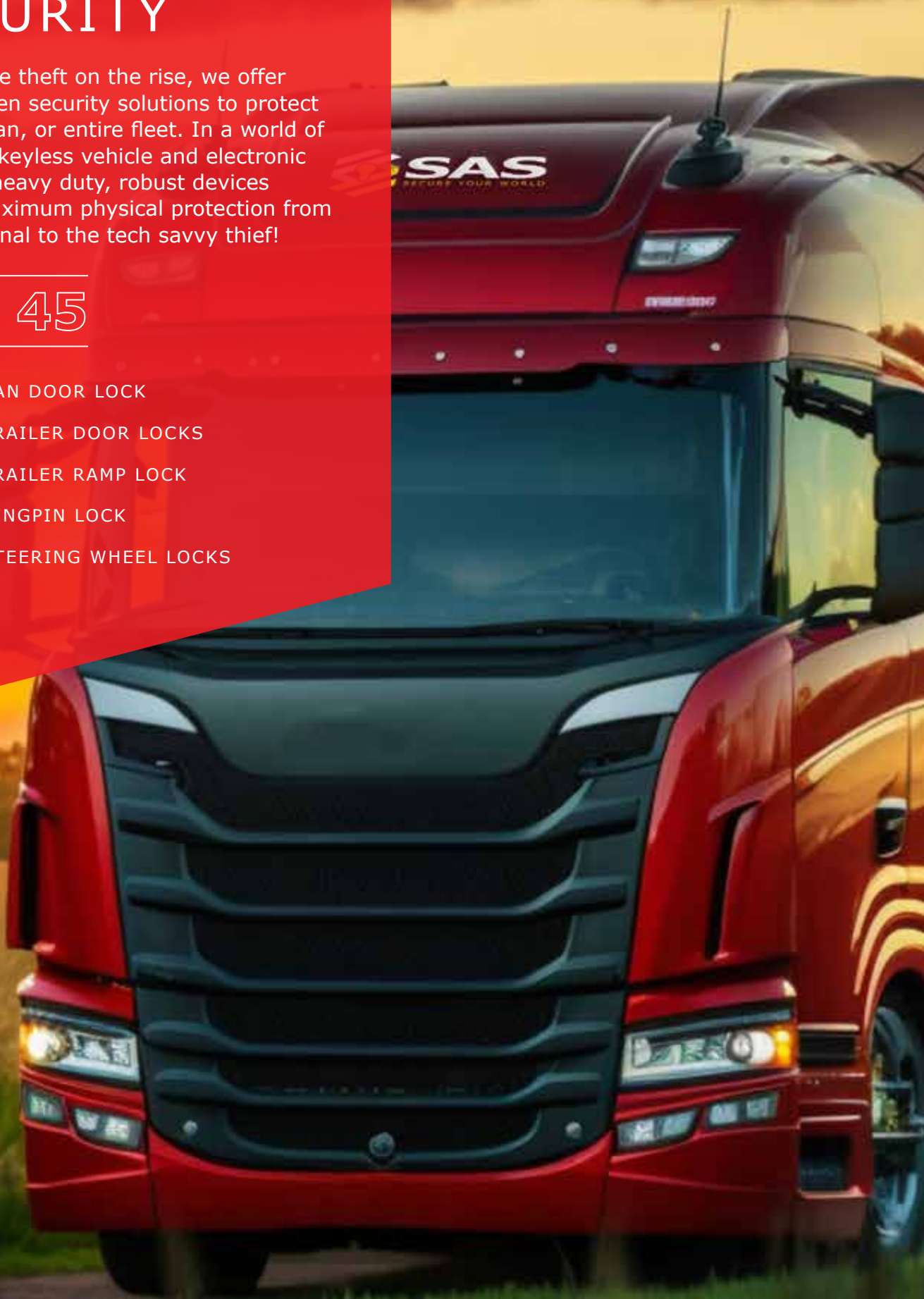

VEHICLE SECURITY

VAN/SHED DOUBLE DOOR LOCKING SYSTEM

This van double door locking system is perfect for securing rear side-hinged van doors. Its tough build stops thieves from pulling or picking it, and the universal fixing holes fit most vans.



- › Fully hardened strong steel construction
- › Universal fixing holes for flexible installation (coach bolt set supplied)
- › Shackleless padlock design for superior security
- › Padlock also available separately - See page 60

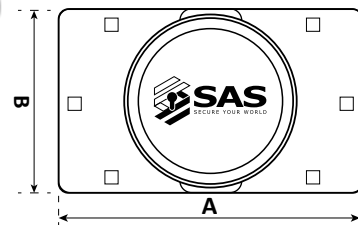

Product Code	Model	A	B	Secure Rating
8500071	VAN/SHED Double Door Lock & Padlock	208	115	7
8500000	VAN/SHED Double Door Hasp only			



Load Restraint Straps - see page 70-71



Trailer Ramp locks - see page 43



Wheelclamps - see pages 16-24



VEHICLE SECURITY

TRAILER DOOR LOCK

The SAS Rear Door Lock is a robust and effective lock designed to secure the rear ramp door handles of Debon box trailers, providing a simple way to protect the valuable goods inside.



- › Robust slide together box lock
- › Simply surrounds handle in twin wall steel enclosure to provide maximum protection
- › Robust anti-drill, anti-pick lock
- › Simple to operate push lock
- › Fits left or right side. Also available as pack of 2 for maximum security



To fit Debon box trailers fitted with this handle.



Product Code	Model	Keys Supplied
5610781	TRAILER DOOR LOCK	3
5610782	TRAILER DOOR LOCK, Keyed Alike	3
5620781	TRAILER DOOR LOCK, Pack of 2 on same key	6

Padlocks
- see pages 58-63



Van double door locking system
- see page 41



TRAILER RAMP LOCK

The SAS Ramp Lock is a heavy-duty, reliable solution for securing ramps on Brian James T Transporter Car trailers, offering an easy and effective way to prevent theft.



- › Robust telescopic design – compact for easy storage when not in use
- › Simple push-to-lock mechanism – keys only required to unlock
- › High-security lock – anti-drill and anti-pick resistant
- › Designed for compatibility with Brian James T Series Car Transporter ramps

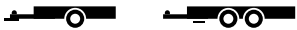

Product Code	Model	Keys Supplied
5710781	BJ TRAILER RAMP LOCK	3
5710782	BJ TRAILER RAMP LOCK, Keyed Alike	3

There may be some minor differences between the model shown in the picture and the final production model.

VEHICLE SECURITY

KING PIN LOCKS

The SAS heavy-duty steel King Pin lock fits easily onto the pivot king pin of the trailer to prevent unauthorised coupling of the tractor unit.

- › Maximum security for 5th wheel trailers
- › Drill and pick resistant high quality lock
- › Can be ordered as keyed alike for fleet operators wanting multiple units
- › Quick and easy to fit
- › Excellent visual and physical deterrent



Very strong steel construction



Product Code	Model
5414729	KING PIN LOCK – Heavy-Duty Steel Construction
5414730	KING PIN LOCK – Heavy-Duty Steel Construction, Keyed Alike

Eye locks for rigid lorry trailers – see pages 36-37



EL50XL



HD BOX EYELOCK

STEERING WHEEL LOCKS

In a world of increasing electronic theft, a physical layer of security is your best defence. While thieves may have the technology to bypass a vehicle's electronics, a robust physical deterrent makes their job too difficult and time-consuming, forcing them to move on.

Universal Crook Steering Wheel Lock

- › Simple and quick fit to steering wheels with 180–310mm inner diameters
- › Sturdy Quad Claw, twin bar design
- › Ratchet design allowing quick fitment without using key
- › Easy to operate integral release lock, supplied with 2 keys
- › Robust PVC coated claws prevent damage to steering wheel
- › Excellent visual & physical deterrent
- › Slide together for easy storage
- › Lightweight and compact for easy use



5880765



5860790



PVC
HOOKS



UNIVERSAL
FIT

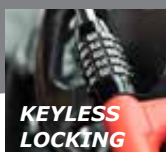

KEYLESS
LOCKING

Additional physical security such as locks and immobilisers are still highly recommended.

Metropolitan Police, Crime Prevention Advice

Large Crook Steering Wheel Lock, Combi Number Lock

- › Fits steering wheels with 235–470mm inner diameters
- › Sturdy dual-hook, telescopic design
- › Keyless with integral 5-digit, 100,000 combination lock
- › Simple and quick to change combi number with tool supplied
- › Blocks access to steering airbag



Product Code	Model
5880765	UNIVERSAL CROOK STEERING WHEEL LOCK
5860790	SAS LARGE CROOK STEERING WHEEL LOCK, Combi Number Lock



5860790



5880765

PROPERTY SECURITY

Our robust, simple, and effective solutions are engineered to provide uncompromising protection for everything you own. They act as a powerful physical deterrent, preventing unauthorised access to your valuables whether they are in your garage, on your driveway, or anywhere on your property.

46 - 53

47-49	GARAGE DOOR SECURITY
50	ROLLER SHUTTER LOCKS
50-51	SHED AND GATE LOCKS
52-53	SECURITY POSTS

**BUILT TO SLOW THEM DOWN,
DESIGNED TO DETER**



**Garage Defender locks
- See page 48**

**Roller Shutter Door Locks
- See page 50**



**For security chains, cables, padlocks, ground anchors
- see pages 54-69**



PROPERTY SECURITY

SECURE A DOOR UP & OVER GARAGE DOOR LOCK

The Secure Shutter Door Lock provides strong, Sold Secure Domestic Silver approved protection for both residential and commercial doors. Made from case-hardened, heavy-duty 5mm steel, this robust lock features a high-visibility red finish to deter tampering.



- › Unique base locking socket sets into concrete
- › Offers high security superior disc lock protection
- › Includes a multi-disc, anti-drill cylinder lock with dust cover
- › Supplied with 3 high security keys
- › Comes with all necessary fixings



GARAGE LOCKING BOLTS

These premium garage locking bolts offer strong, simple protection for both wood and metal garage doors. Each lock comes with three high-security keys, providing excellent all-round security for sectional and up-and-over doors.

- › Can be fitted to Garage Door either vertically or horizontally.
- › Offers dual-side key access for greater flexibility
- › Hardened Bolts shoot 70mm into frame or ground sleeve.
- › Complete with M8 x 70mm Coach bolts, nuts and escutcheons.
- › Fits doors up to 38mm thick

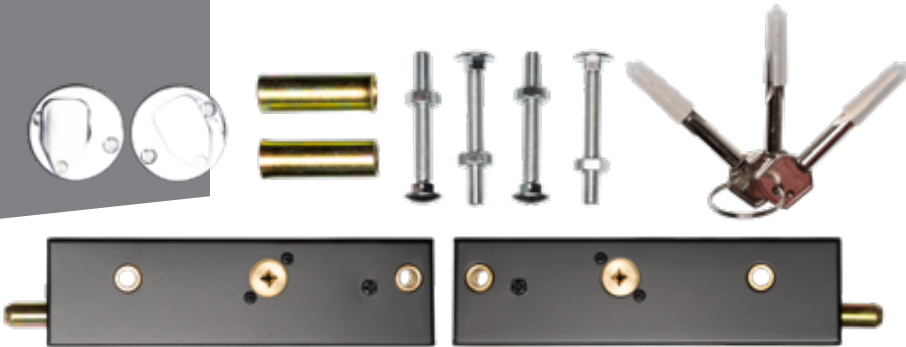

Product Code	Model
6410044	PJB317 - Secure A Door Up & Over Garage Door Lock
6240067	PJB304 - Garage Locking Bolts

PROPERTY SECURITY

PJB GARAGE DEFENDER

Protect your up-and-over garage door with the trusted PJB Garage Defender. This robust unit holds the door in place, physically blocking all tilt movement to prevent forced entry.



- › Solid Steel Construction
- › High-security steel SAS HD85-75 padlock
- › Base plate - 78mm x 205mm x 5mm
- › 2 x concrete fixing bolts included
- › Base plate available for tarmac fitting



PJB GARAGE DEFENDER MASTER

The PJB Garage Defender Master gives you the same trusted strength as the original Garage Defender, but with an alternative locking system. Stop break-ins before they even start!



- › Solid Steel Construction
- › Shackleless round lock with 73mm protected lock body and 5-pin removable barrel
- › Base plate - 78mm x 205mm x 5mm
- › 2 x concrete fixing bolts included
- › Base plate available for tarmac fitting





Product Code	GARAGE DEFENDER	Colour	Base plate
6111875	PJB302 - Garage Defender	Red	Bolt Down
6111876	PJB302 - Garage Defender, Keyed alike		
6112875	PJB302T - Garage Defender		Tarmac
6112876	PJB302T - Garage Defender, Keyed alike		
6114875	PJB320 - Garage Defender	White	Bolt Down
6114876	PJB320 - Garage Defender, Keyed alike		
6115875	PJB320T - Garage Defender		Tarmac
6115876	PJB320T - Garage Defender, Keyed alike		

Product Code	GARAGE DEFENDER MASTER	Colour	Base plate
6121871	PJB301 - Garage Defender Master	Black	Bolt Down
6121872	PJB301 - Garage Defender Master, Keyed alike		
6122871	PJB301T - Garage Defender Master		Tarmac
6122872	PJB301T - Garage Defender Master		
6124871	PJB321 - Garage Defender Master	White	Bolt Down
6124872	PJB321 - Garage Defender Master, Keyed alike		
6125871	PJB321T - Garage Defender Master		Tarmac
6125872	PJB321T - Garage Defender Master, Keyed alike		

Replacement locks - see Pages 59-60

Parts and Accessories - See Pages 75

PROPERTY SECURITY

ROLLER SHUTTER DOOR LOCKS

Comprising of oval lock holders for welding to roller shutter track both sides, and removable bullet locks to insert to secure the shutter.



- › High security bullet locks supplied in pairs with oval lock housings
- › Complete with 2 keys per lock, each pair of locks keyed alike
- › Adds maximum security to your roller shutters
- › Pin length 53mm



GATE/SHED LOCK

This single lock is suitable for gates, sheds or outdoor storage space. Offering key access from both sides, it features a hardened shoot bolt and keep, and comes with two high-security star keys.

- › Hardened Bolts shoots 70mm into keep
- › Complete with M8 x 70mm Coach bolts and nuts.
- › Fits doors up to 38mm thick



Product Code	Model
6610016	ROLLER SHUTTER DOOR LOCKS (set of 2 oval lock holders and 2 bullet locks)
6740067	PJB319 - Gate/Shed Lock

8500071 VAN/SHED DOUBLE DOOR LOCKING SYSTEM

This van double door locking system is perfect for securing rear side-hinged van doors. Its tough build stops thieves from pulling or picking it, and the universal fixing holes fit most vans.



Padlock also available separately - See page 60



- › Fully hardened strong steel construction
- › Universal fixing holes for flexible installation (coach bolt set supplied)
- › Shackle-less padlock design for superior security

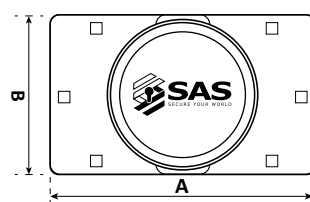

FEDERAL 4025 HASP AND PADLOCK

This Sold Secure Silver rated hasp is built for maximum protection. It is ideal for securing gates, sheds and doors on many applications.



- › Satin Nickel plated and hardened steel body and staple
- › Concealed fixings prevent tampering (fixings included)
- › Anti-cut molybdenum shackle padlock, with anti-bump, anti-drill, anti-pick cylinder and sliding plate cover.

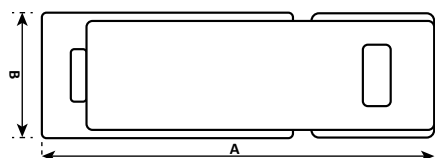

UNIVERSAL SECURITY HASP



This hasp is a robust solution for securing single or double doors. Its laser-cut precision provide a perfect fit, while the zinc-plated finish ensures long-lasting durability.

- › Ideal for securing gates, sheds and doors
- › Will fit most style padlocks - choose a closed shackle style padlock for total security
- › Built-in handle design
- › Includes fixing kit

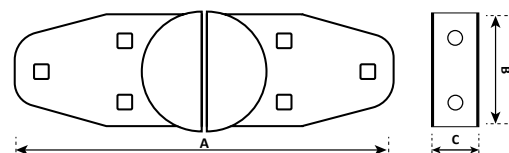

Product Code	Model	A	B	C	Secure Rating
8500071	VAN/SHED Double Door Hasp & Padlock	208	115	-	7
8500000	VAN/SHED Double Door Hasp only				
8551055	Federal 4025 Hasp & padlock	227-265	77	-	6
8551000	Federal 4025 Hasp only				
8521037	Universal Security Hasp, w Fixing Kit & Master M50D padlock	246	80	70	6
8521000	Universal Security Hasp & Fixing Kit only				

Dimensions shown are an approximate (mm)

PROPERTY SECURITY

SECURITY POSTS

A complete range of fixed or removable security posts for securing any driveway or entrance to your property.



- › Made from heavy-duty 80 x 80mm steel box section - 800mm post height
- › Available in various options either removable, folding or fixed
- › Powder coated black finish with reflective stickers

TOW BALL ADAPTOR

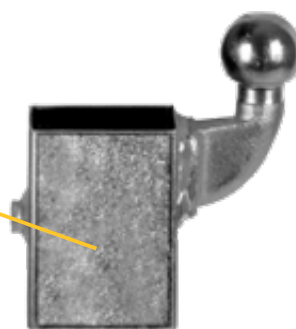

Optional tow ball Adaptor allows you to hitch your caravan or trailer to the post. Gain extra security by locking trailer or caravan to post and use a SAS hitchlock too – the more you lock together the better!

FIXED

HD CONCRETE IN



6381000

- › Designed to match folding and removeable posts, for positions where no access is required
- › Reinforcing bars supplied
- › Simply concrete into the ground

FIXED

HD BOLT DOWN



6361000

- › Designed to match folding and removeable posts, for positions where no access is required
- › Bolt down security fixing, with added ball bearing security
- › Bolt down to concrete to save digging up the ground, using expandable security bolts supplied

Fix into the concrete with the expandable security bolts, then secure by hammering ball bearing into the Allen slot to stop removal.



ADJUSTABLE

HD FOLDING



6331075

- › Bolt down security fixing, with added ball bearing security
- › Bolt down to concrete to save digging up the ground, using expandable security bolts supplied
- › Simply lift and fold forward or backwards to gain access
- › Smart but simple internal locking system
- › Easily accessible lock on side of post, mounted away from ground dirt



Simple lift and fold system

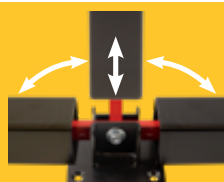

HD REMOVABLE



6311075

- › Anti-drill and anti pick lock at the top away from ground dirt
- › Robust handles for easy lifting for removal
- › Robust zinc-plated ground socket with hinged lid gives flush finish when post removed



Can be mounted flush to the ground

Product Code	Description	Dimensions
6311075	HD REMOVABLE SECURITY POST, with ground Socket	800mm above ground
6311076	HD REMOVABLE SECURITY POST, with ground socket - Keyed Alike	80x80mm HD Box Section
6331075	HD FOLDING SECURITY POST, Bolt Down	80x80mm HD Box Section
6331076	HD FOLDING SECURITY POST, Bolt Down - Keyed Alike	800mm height
6361000	HD BOLT DOWN SECURITY POST, Fixed	
6381000	HD CONCRETE IN SECURITY POST, Fixed	80x80mm HD Box Section
6301100	Optional Tow Ball Hitch Adaptor to fit HD SECURITY POST	800mm above ground
9630010	Replacement Ground Socket, zinc-plated with hinged lid	for Removeable & Folding Posts
		275mm into ground

Replacement locks - see Page 73
Parts & Accessories - See Pages 75

UNIVERSAL SECURITY

We provide versatile solutions for your everyday security needs. Our universal security products, including padlocks, chains, cables, and ground anchors, are designed to provide durable, reliable security keeping your most valued assets safe, from vehicles and trailers to tools and equipment.

54 - 71

55 STEEL BRAIDED CABLES & LOCKS

56-57 SECURITY CHAINS & LOCKS

58-63 PADLOCKS

64-69 GROUND ANCHORS

70-71 LOAD RESTRAINT STRAPS

There are many different applications, some requiring higher security whilst other applications need a lighter duty approach, to save weight or cost. We have rated the products in this section, to enable a quick comparison, but this is a guide only.

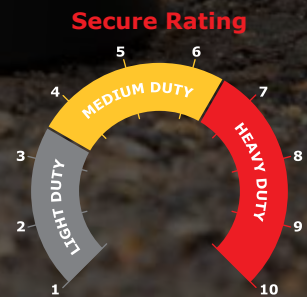

Chains & Cables
- see pages 55-57



See pages 58-63

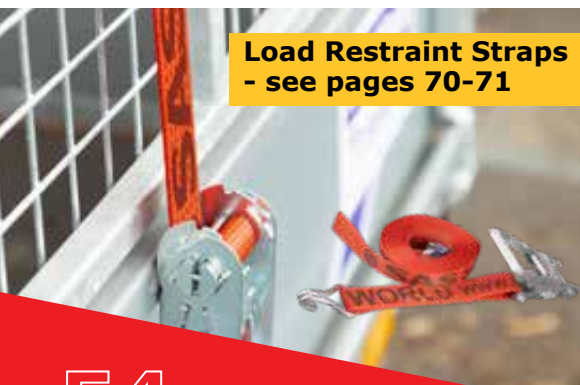

Load Restraint Straps
- see pages 70-71



ScrewIn Ground Anchor
- see page 69

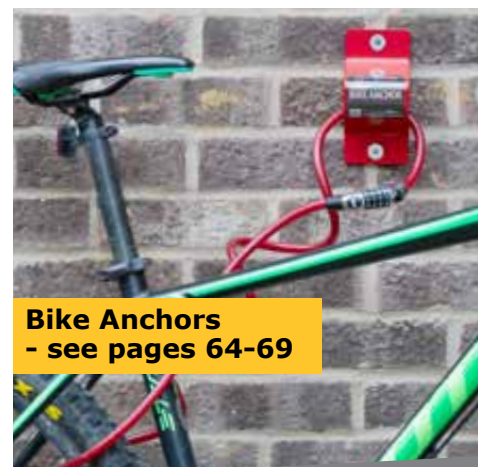

Bike Anchors
- see pages 64-69

SECURITY STEEL BRAIDED CABLES

Strong flexible braided security cables are great for locking up equipment. Just thread through and use a padlock through the loop ends to secure. If you need longer you can simply join cables either using a padlock or by a lasso method.

LOOP CABLE



- › 12mm high-tensile steel braided cable
- › Vinyl coated to protect your paintwork
- › 2 lengths available 2500 & 6000mm

Lasso one end of the steel braided cable around a post, trailer frame or ground anchor to effectively double the useful length.



LOOP CABLE & LOCK



- › Includes a HD43 heavy-duty mini shackle padlock, with 3 keys
- › 2500 mm x 12mm high-tensile steel braided cable
- › Vinyl coated to protect your paintwork

For more information on HD43 padlock, including dimensions - see page 61

Lasso method of joining cables



COMBI LOCK



- › A cost effective, lightweight and easy to use security cable.
- › 1800x12mm high-tensile steel self-coiling cable
- › Vinyl coated to protect paintwork
- › Re-settable 4-digit combination
- › No keys to lose!

› Built-in LED light enables easy use in the dark



Product Code	Model	Secure Rating
8242500	LOOP CABLE 2500x12mm Steel Braided Security Cable	5
8242543	LOOP CABLE 2500x12mm Steel Braided Security Cable with HD43 Padlock	5
8246000	LOOP CABLE 6000x12mm Steel Braided Security Cable	5
8221890	COMBI 1800x12mm Steel Braided Security Cable with Combination Lock	4

HEAVY-DUTY SQUARE-SHACKLE SECURITY CHAIN

8132065



8162043



8161543



The square-shackle chain is a secure mid-range chain which is light enough to be easily carried, but still extremely secure to deter would-be thieves. The chain is ideal for securing your trailer, caravan, motorbike, or machinery to a ground anchor, when stored overnight, short-term, or long term.

The hardened steel square-shackle design gives the chain ample room to be locked with a heavy-duty padlock. We recommend using this square-shackle chain with a SAS ground anchor to increase the security by locking down your equipment.

- › 14 and 10mm square-shackle chain links made from high grade steel
- › Case hardened chain resists bolt croppers
- › HD43 Tough durable double-locking padlock with hardened 12.7mm steel shackle
- › Supplied complete with 3 keys
- › Zinc-plated chain to prevent corrosion
- › Non scratch heavy-duty woven cloth-covered chain sleeve

Product Code	Model	Secure Rating
8132065	HEAVY-DUTY SQ-SHACKLE CHAIN 2000x14mm & Monster Padlock	8
8161543	HEAVY-DUTY SQ-SHACKLE CHAIN 1500x10mm & HD43 Padlock	7
8162043	HEAVY-DUTY SQ-SHACKLE CHAIN 2000x10mm & HD43 Padlock	7
8132000	HEAVY-DUTY SQ-SHACKLE CHAIN 2000x14mm only	8
8161500	HEAVY-DUTY SQ-SHACKLE CHAIN 1500x10mm only	7
8162000	HEAVY-DUTY SQ-SHACKLE CHAIN 2000x10mm only	7

For more information on padlocks, including dimensions see pages 58 & 61



ROUND SHACKLE SECURITY CHAIN

811 NEMESIS



This 16mm round link chain, made from hardened Cro-Mo steel reinforced with titanium alloy, offers incredible strength.

- › Case hardened chain resist bolt croppers
- › Long chain links reduce weight

8111551



- › Sold Secure Motorcycle Gold approved if used with Nemesis 8301651 Padlock

8171517



This 8mm round link chain offers an excellent combination of strength and convenience, light enough to handle but still incredibly strong and secure to give you reassurance.

- › 8mm hardened steel chain
- › Protective cloth chain cover
- › Supplied with UB60 60mm brass padlock and 3 keys

8171575



- › Or supplied with a tough C-TYPE padlock and 5 keys

8181015



This 6mm round link chain offers the convenience of a light-weight chain to protect against the opportunist thief.

- › 6mm hardened steel chain
- › Protective cloth chain cover
- › Supplied with UB50 50mm brass padlock and 3 keys

THE HARDER YOU MAKE IT, THE SAFER IT STAYS



Product Code	Model	Secure Rating
8111551	NEMESIS 1500x16mm chain with NEMESIS padlock	9
8112051	NEMESIS 2000x16mm chain with NEMESIS padlock	9
8111500	NEMESIS 1500x16mm chain only	9
8112000	NEMESIS 2000x16mm chain only	9
8171517	MULTI-PURPOSE CHAIN 1500x8mm with UB60 Padlock	4
8171575	MULTI-PURPOSE CHAIN 1500x8mm with C-TYPE Padlock	5
8171500	MULTI-PURPOSE CHAIN 1500x8mm only	4
8181015	MULTI-PURPOSE CHAIN 1000x6mm with UB50 Padlock	3

For more information on padlocks, including dimensions see pages 58-63

PADLOCKS

Our selection of heavy-duty padlocks includes our reliable SAS padlocks alongside the best padlocks on the market for applications where an SAS padlock is not suitable for your application. These versatile locks are designed to work on their own or with other SAS products to secure a wide range of your equipment and assets.

MONSTER CLOSED SHACKLE

8301665



- › Heavy Duty Monster Padlock supplied with 3 keys
- › Sold Secure Gold rated padlock for maximum security
- › Hardened boron steel armour casing
- › Double locking mechanism and sliding key dust cover

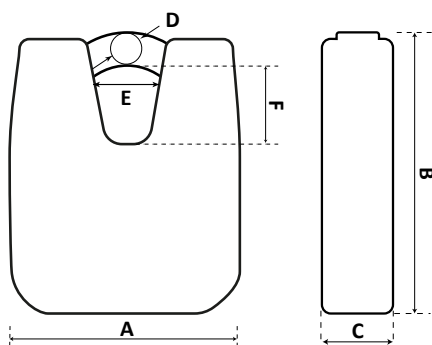

FEDERAL FD730 SS

8351055



- › Sold Secure Silver approved for trusted security
- › CEN 4 security rating for high-grade protection
- › Hardened solid steel body for long-lasting durability
- › Molybdenum 11mm steel shackle for cut resistance
- › Double ball bearing stainless steel locking system
- › Anti-drill, bumping, and picking resistant cover plate
- › Keys removable only when locked

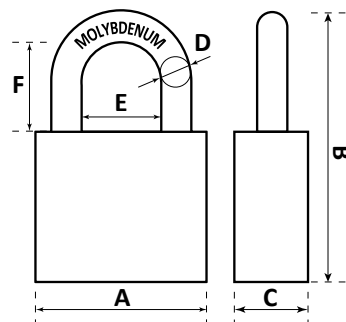

C-TYPE SOLID STEEL

8300075



- › Includes five advanced security keys
- › 12mm diameter shackle
- › 41mm shackle opening for flexible use
- › Solid steel body for toughness
- › Rotating shackle pin blocks saw cutting
- › Brass locking cylinder resists rust

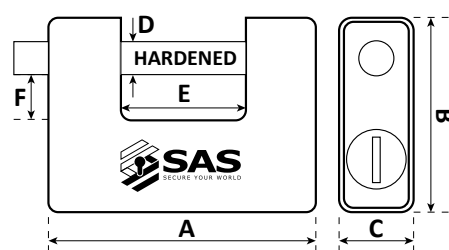

For Van Hasps
- see page 41

For ground anchors
- see pages 64-69



PADLOCKS

HD85-75 SOLID HARDENED STEEL

8375085



- › Features 75mm hardened stainless steel for extra strength
- › Secures containers, shutter doors, and other items
- › Works well with security chains or cables
- › Compatible with PJB garage defender systems
- › Includes five keys for easy key management

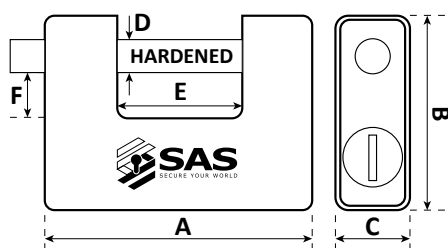

DC70 DISC PADLOCK

8300033



- › Heavy-duty stainless steel disc padlock.
- › Made from stainless steel
- › 9.5mm steel shackle

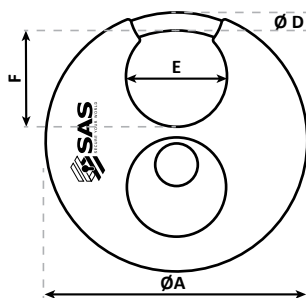

MASTER LOCK EXCELL M50

8301837



- › Rust-free stainless steel casing for lasting durability
- › 12mm Boron-Carbide octagonal shackle, 50% stronger than hardened steel
- › Accepts two 10mm links or one link up to 16mm
- › Anti-drill plate prevents tampering and force attacks
- › Key-retaining system keeps lock closed unless key is inserted
- › Four keys included for easy sharing and spares

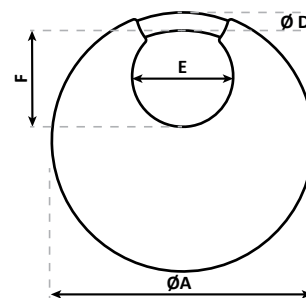

Product Code	Padlock Model	A	B	C	D	E	F	Secure Rating
8301665	MONSTER Closed Shackle	71	87	36	11	19	23	8
8351055	FEDERAL FD730 SS	61	98	32	11	31	26	7
8300075	C-TYPE Solid Steel	94	70	29	13	40	17	7
8300076	C-TYPE Solid Steel,Keyed Alike							
8375085	HD85-75 Solid Hardened Steel	75	62	28	11.7	27.5	15	9
8375086	HD85-75 Solid Hardened,Keyed Alike							
8300033	DC70 Disc Padlock, Stainless Steel	68	-	-	9.5	19	16	5
8301837	MASTER LOCK EXCELL M50	80	-	-	10.7	22	17.5	7

Dimensions shown are an approximate (mm)

PADLOCKS

UNTOUCHABLE DISC-LOCK

8440051



- › Offers high security superior disc lock protection
- › Features a compact 21mm double locking shackle
- › Measures an overall diameter of 40mm
- › Tested to six-ton pull strength for durability
- › Includes a multi-disc, anti-drill cylinder with dust cover
- › Durable chrome-plated finish

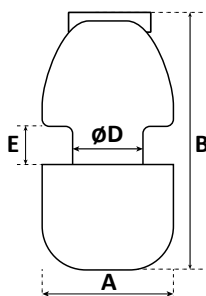

HD71 ROUND PADLOCK

8300071



- › Strong hardened steel body with chrome plating
- › Shackle-less design for enhanced security
- › High-security lock resists picking and tampering
- › Locked shackle pin secures firmly in place

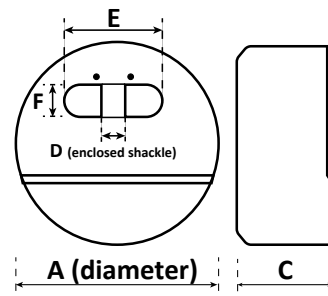

HD43 PADLOCK

8300043



- › A tough mini shackle padlock that is ideal for use with SAS chains or cables.
- › Made from tough hardened steel
- › Double locking 12.7mm case hardened steel shackle
- › Twisting key way dust cover
- › Anti-pick key design
- › Also available keyed alike

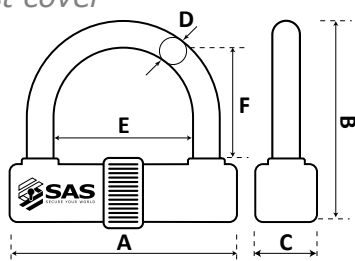

NEMESIS PADLOCK

8301651



- › Ultra-strong padlock, ideal for use with the Nemesis chain for the ultimate security solution.
- › High security, independently approved padlock
- › Sold Secure Gold approved as disc lock for motorcycles
- › Double-locking, anti-pick lock mechanism with a 16mm hardened steel shackle
- › Dust cover to protect the lock barrel from dirt ingress

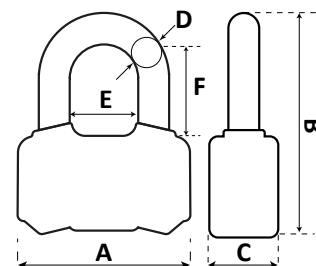

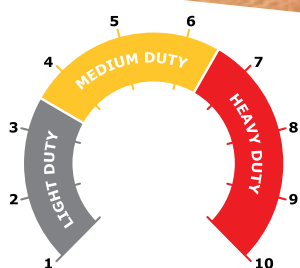

Product Code	Model	A	B	C	D	E	F	Secure Rating
8440051	UNTOUCHABLE DISC-LOCK	40	81	-	21	14	-	7
8300071	HD71 ROUND Hardened Steel Padlock	73	-	37	10	45	15	7
8300072	HD71 ROUND Hardened Steel Padlock, Keyed Alike							
8300043	HD43 LOCK 12.7mm D Padlock	99	97	35.2	15.4	47	46	6
8300044	HD43 LOCK 12.7mm D Padlock, Keyed Alike							
8301651	NEMESIS 16mm D Padlock	95	122	39	18	39	52	9

Dimensions shown are an approximate maximum (mm) - shackle diameter includes a rubber covering if fitted.

UNIVERSAL SECURITY

KB21 UNILOCK

The KB21 Unilock Rectangular Padlock is a versatile security solution for tight spaces. Its unique design features a large opening with a slim shackle, making it perfect for securing Knott trailer hitches, Blue Line box trailer rear shutter doors, and Ifor Williams trailer rear doors or ramps. Constructed with a solid brass body and a hardened steel shackle, this padlock delivers reliable strength and long-lasting durability.



- › Solid brass lock body, giving great durability
- › Enclosed hardened chrome plated steel shackle, for increased strength
- › High precision 6 pin brass lock and cylinder core, for a smooth operation
- › Supplied with 3 nickel plated brass keys
- › Also available keyed alike



Blue Line box trailer rear shutter door or ramp catches



KB21 UNILOCK is also designed to fit a Knott pressed steel trailer hitch, with a curved handle and hole right through - see page 34



KB21 UNILOCK



50MM PADLOCK



8304021

SET OF 4 PADLOCKS AVAILABLE FOR IFOR WILLIAMS BOX TRAILER REAR DOOR/RAMP

UNIVERSAL BRASS PADLOCK

A great range of general-purpose padlocks with a solid brass body, making them very versatile for use in a wide range of environments and applications.

The shackle is heat-treated hardened steel, with a secure double locking mechanism. The padlock also has a high precision lock mechanism with a brass cylinder core and 5 brass key-way pins, this is coupled with stainless steel springs giving the padlock higher security, good durability, and resistance, with a smooth operation.

UB40 PADLOCK

- 40mm Brass Padlock
- Tough hardened steel shackle
- Supplied in packs of two with 6 keys, that will operate both padlocks

UB50 PADLOCK



- 50mm Brass Padlock
- Tough hardened steel shackle
- Supplied in packs of two with 6 keys, that will operate both padlocks

UB60 PADLOCK

- 60mm Brass Padlock
- Tough hardened steel shackle
- Supplied in packs of two with 6 keys, that will operate both padlocks

Product Code	Model	A	B	C	D	E	F	Secure Rating
8300021	KB21 UNILOCK	80	55	18	7	42	19.9	4
8300022	KB21 UNILOCK, Keyed Alike							
8304021	1x KB21 UNILOCK + 3x UB50, Keyed Alike	See Each Padlock's Dimensions						4
8340213	UB40, 40mm brass body, Pk 2	40	62.2	13.8	6.2	21.6	23	3
8350215	UB50, 50mm brass body, Pk 2	50	76	16	8	28	28	4
8350216	UB50, 50mm Brass Body, Keyed Alike, Pk 2							
8360217	UB60, 60mm brass body, Pk 2	60	89	18.5	10	32	36	5

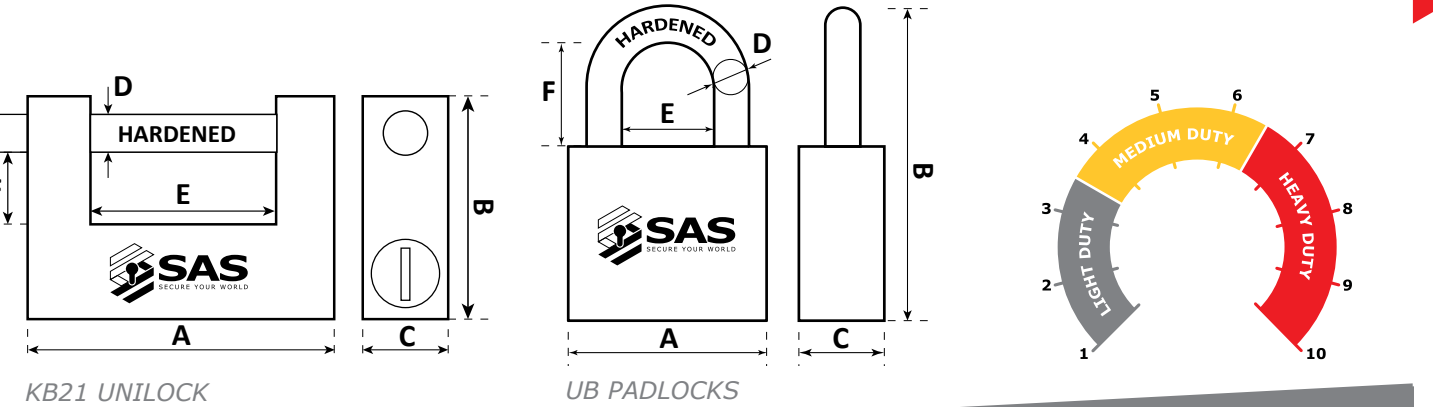
Dimensions shown are an approximate maximum (mm)



DOCKING STATIONS AND GROUND ANCHORS

HEAVY-DUTY DOCKING STATION

8611000



This heavy-duty docking station provides unbeatable security with its rigid, forged steel construction and Thatcham Approval.

- › Sliding pin lock fits chains up to 16mm
- › Semi-elliptical high-security key resists picking
- › Plastic cover prevents dust and water ingress
- › Includes 4 x high-security fixing bolts
- › Suitable for floor or wall mounting

HOOK WALL ANCHOR

8602000



This hook wall anchor provides strong and reliable chain security. Its durable, weather-resistant finish ensures lasting protection. Available for purchase with or without the untouchable disc lock and a 14mm chain.

- › Robust 10mm lasercut steel hook
- › Fits chains with 50-100mm internal aperture length
- › 2 x M10 x 70mm countersunk security screws with shield anchors, steel ball inserts included



PJB561- Hook Wall Anchor, with 14x2000mm chain and Untouchable Lock

Fix into the masonry with the expandable security bolts, then secure by hammering ball bearing into the Allen slot to stop removal.





Shown with the SAS heavy-duty 14x2000mm chain and Monster lock - see page 56

TAURUS BULL RING BOLT DOWN ANCHOR

8622000



The Taurus Bull Ring is a heavy-duty bolt-down ground anchor, which is approved to Sold Secure Gold standard for maximum peace of mind.

- › 150mm square base plate
- › 100mm x 80mm opening accommodates a wide range of chains
- › 22mm heavy duty hardened shackle
- › Tough weather resistant black powder coat finish
- › Suitable for ground or wall mounting
- › 4 x security fixing anchor bolts, steel ball inserts and Allen key included

TAURUS BULL RING CONCRETE IN ANCHOR

8626000



The Taurus Bullring is a heavy-duty built-in ground anchor which is approved to Sold Secure Gold standard for maximum peace of mind.

- › 250mm post length is set into concrete for a permanent and secure hold
- › 100mm x 80mm opening accommodates a wide range of chains
- › 22mm heavy duty hardened shackle
- › Tough weather resistant black powder coat finish

Product Code	Model	Secure Rating
8611000	HEAVY-DUTY DOCKING STATION, bolt down	9
8602000	PJB562 - Hook Wall Anchor	7
8602044	PJB561 - Hook Wall Anchor, with Untouchable Lock	7
8602344	PJB561 - Hook Wall Anchor, with Untouchable Lock & 14x2000mm Chain	8
8622000	PJB549 - Taurus Bull Ring Anchor, Bolt down	8
8626000	PJB552 - Taurus Bull Ring Built In Anchor -Concrete In	8

GROUND ANCHORS

ROTAFORCE

8631000



This rotating ground anchor has a durable rotating steel head for flexible locking angles, without losing strength.

- › 26mm case-hardened steel head resists cutting
- › 59mm opening fits various chains
- › 4 x high-security bolts with bolt covers included

TERRAFORCE

8655000



This concrete in ground anchor provides unbeatable strength and secure fixing. Made from case-hardened steel, it resists cutting and pulling.

- › 21mm thick ring resists cutting and levering
- › 59mm internal diameter fits chains up to 16mm
- › Two cross-brace pins prevent upward removal

BRUTEFORCE

8681000



This mini anchor offers strong security for scooters and bicycles.

- › 5mm hardened steel for extra strength
- › 120mm x 88mm back plate
- › 70mm tapering to 50mm x 40mm high bridge
- › Black powder-coated finish protects against corrosion
- › 2 x security fixings, steel ball inserts, and an Allen key included

LOCK IT BIKE ANCHOR

8662000



This simple but effective anchor is compact but offers excellent security.

- › Fits chains, cables or U locks up to 13mm
- › Tough red weather resistance powder coating
- › 2 x M10 x 70mm countersunk security fixing anchor bolts, steel balls and Allen key included
- › Suitable for ground or wall mounting

BIKE-BRUTE ANCHOR

8692000



This compact anchor offers a welded and folded anchor with a strong back plate for extra durability.

- › Fits chains, cables or U locks up to 10mm
- › Solid Zinc plated finish for extreme weather resistance
- › Suitable for ground or wall mounting
- › 2 x M10 x 70mm countersunk security fixing anchor bolts, steel balls and Allen key included.

DOUBLE BRIDGE ANCHOR

8642500



This double bridge fixed bolt down anchor is compact but offers heavy-duty security.

- › Inner 5mm & outer 8mm thick solid steel bridges
- › 37mm aperture enables use with chains up to 14mm
- › Tough red weather resistant powder coating
- › 4 x security fixing anchor bolts, steel ball inserts and Allen key included

BULL POINT ANCHOR

8642000



This single bridge fixed bolt down anchor is heavy duty and compact.

- › 8mm thick solid steel bridge for increased security
- › 48mm aperture enables use with chains up to 14mm
- › Tough red weather resistant powder coating
- › 4 x security fixing anchor bolts, steel ball inserts and Allen key included

Product Code	Model	Secure Rating
8631000	ROTAFORCE Rotating Ground Anchor, bolt down	8
8655000	TERRAFORCE Ground Anchor, concrete-in	8
8681000	BRUTEFORCE Ground Anchor, bolt down	4
8642500	PJB509 - Red Alert Double Bridge Anchor	9
8642000	PJB538 - Bull Point Anchor	8
8662000	PJB506 - Lock It Bike Anchor (red/folded)	4
8692000	PJB535 - Bike Brute Anchor (zinc/welded)	4



GROUND ANCHORS

The SAS Secure Anchor range offers a simple but effective way to secure your equipment, when used with a security chain or cable coupled with a padlock. Simply bolt to a wall or concrete drive for an effective anchor point.

SECURE ANCHOR

8675000



- › Double wall thickness secure anchor for the more demanding applications
- › Can be fitted to concrete floors, driveways or concrete/brick walls
- › Easy to fit with fitting instructions included
- › Fixing kit supplied; 2 x high security expansion bolts, 2 x steel plugs and 2 x anti-tamper ball-bearings
- › The strength of the installation is dependent on the quality of the floor/wall material
- › Great for use with the SAS Heavy-Duty Square Shackle Chains – see page 56

SECURE ANCHOR MINI

8685000



- › Robust secure anchor
- › Can be fitted to concrete floors, driveways or concrete/brick walls
- › Easy to fit - Fitting instructions included
- › Fixing kit supplied; 2 x high security expansion bolts, 2 x steel plugs and 2 x anti-tamper ball-bearings
- › The strength of the installation is dependent on the quality of the floor/wall material
- › Great for use with the SAS Multi-Purpose Chains - see page 57 or with the security steel braided cables - see page 55



SCREWIN GROUND ANCHOR

A heavy-duty ground anchor, simply screw into the ground and gain a great anchoring point to lock your trailer, caravan, motor bike, quad bike, aircraft and more, using a padlock with chain or cable. When finished, unscrew and remove to use another day in another place.

- › Heavy-duty permanent or semi-permanent security anchor to secure any portable valuable item
- › Portable for extra adaptability
- › Extremely strong and easy to use
- › Screw in and out again to move on to a new location
- › 50mm hardened double shackle loops for easy connection
- › Red powder coated paint finish
- › Supplied with winding in bar

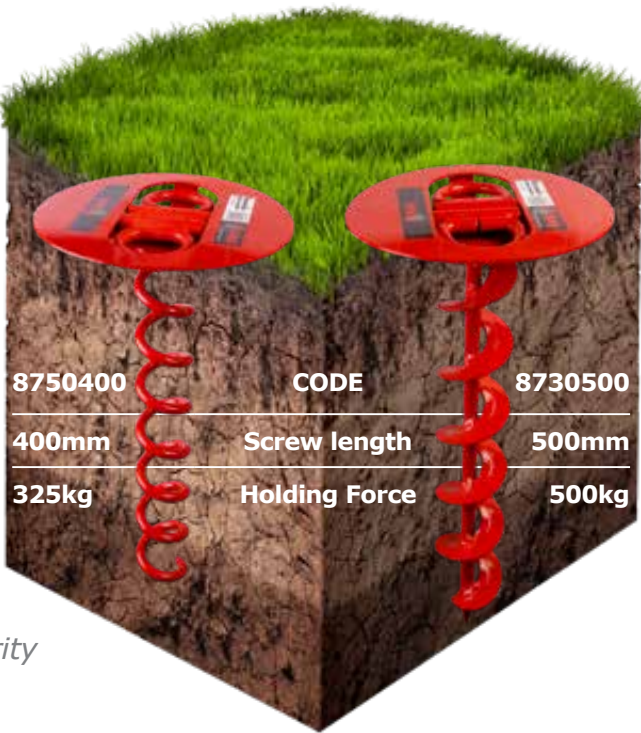

Product Code	Model	Secure Rating
8675000	SECURE ANCHOR, bolt down ground anchor	6
8685000	SECURE ANCHOR MINI, bolt down ground anchor	4
8730500	SCREWIN50 Ground Anchor	2
8750400	SCREWIN40 Ground Anchor	2



LOAD RESTRAINT STRAPS

A range of high-quality load restraint straps, both ratchet and cam buckle style. Used by many to secure equipment or materials on a truck or trailer, but useful for many other purposes.

RS3-5 MINI RATCHET STRAP



8831502

- › Set of 2 ratchet straps
- › Non-locking ratchet buckle
- › Complies with EN12195-2
- › 25mm strap width
- › 5m overall length
- › Welded claw hooks

CB1-4 CAM BUCKLE STRAP



8814402

- › Set of 2 Light-duty straps
- › Pull tight cam buckle
- › Complies with EN12195-2
- › 25mm strap width
- › 4m overall length
- › Endless strap type

STRAP ACCESSORIES

HD WHEEL CHOKERS



8894704

- › Set of 4, Soft eye chokers with wear sleeves, secures wheels without scratching or scuffing alloys
- › Fully tested to EN1492-2
- › 470mm overall length

WEAR SLEEVES



8896304

- › 300mm overall length
- › 60mm sleeve for use with RS5 50mm HD straps
- › Set of 4



RS5-4 HD RATCHET STRAP



**4m length
8855400**

- » Heavy-duty ratchet strap
- » Non-locking ratchet buckle
- » Complies with EN12195-2
- » 50mm strap width
- » Welded claw hooks

RS5-6 HD RATCHET STRAP



**6m length
8855600**

- » Heavy-duty ratchet strap
- » Non-locking ratchet buckle
- » Complies with EN12195-2
- » 50mm strap width
- » Welded claw hooks

VEHICLE STRAP DOWN KIT

Strap down a vehicle on a car transporter trailer or truck using this handy kit, made using the high-quality straps from the SAS range.

KIT INCLUDES: -

- 4x RS5-4 HD Ratchet Straps
- 4x Wheel Chokers with wear sleeves



Product Code	Description	Strap Rating	Breaking Strain	Strap Width	Strap Length
8814402	CB1-4 Cam Buckle Strap, endless, Set of 2	400 daN	800kg	25mm	4m
8831502	RS3-5 Mini Ratchet Strap, claw hooks, Set of 2	450 daN	900kg	25mm	5m
8855400	RS5-4 Heavy Duty Ratchet Strap, claw hooks	2500 daN	5000kg	50mm	4m
8855600	RS5-6 Heavy Duty Ratchet Strap, claw hooks	2500 daN	5000kg	50mm	6m
8855444	VEHICLE STRAP DOWN KIT, 4 Straps & Chokers	2500 daN	5000kg	50mm	4m
8894704	WHEEL CHOKER with Wear Sleeve, Set of 4	1000kg	7000kg	45mm	470mm
8896304	WEAR SLEEVE for RS5 Ratchet Strap, Set of 4	-	-	60mm	300mm

More sizes are available on request, subject to minimum order requirements – please notify us of your requirements.
(Not suitable for lifting purposes)

ACCESSORIES & SPARE PARTS

Our products are designed for serviceability and long-lasting performance. We offer a wide range of accessories and spare parts, from replacement locks and keys to care products and fixings. You can easily maintain or upgrade your SAS product, making your initial investment last for years to come.

72 - 75

- 72 LUBRICANTS
- 73-74 REPLACEMENT LOCKS
- 74-75 PARTS & ACCESSORIES



CARE PRODUCTS

GENERAL PURPOSE GREASE

A tough waterproof grease that outperforms lithium and synthetic alternatives, delivering lasting lubrication and corrosion protection. Stays put in wet, dirty, or high-load conditions to keep components moving smoothly.

- › Waterproof & wash-out resistant
- › Multi-grease compatible
- › Thermally stable

Great For:

- › Wheel clamps
- › Exposed moving parts



GENERAL PROTECTANT SPRAY

A versatile, long-lasting protectant that forms a strong, water-repellent coating to block moisture and prevent corrosion. Ideal for safeguarding components during storage or winter conditions, it helps maintain the performance and condition of metal and rubber parts.

- › Repels moisture effectively
- › Shields against dirt and grime
- › Durable coating for lasting protection

Great For:

- › Lubricating and protecting locks
- › Long-term and overwinter storage of components



THREAD LOCK

A reliable medium strength thread lock designed to secure bolts and fasteners against vibration and loosening. Provides strong hold while still allowing disassembly when needed.

- › Prevents loosening from vibration
- › Protects threads from wear and corrosion
- › Removable with standard tools

Great For:

- › Securing bolts and fasteners
- › Applications requiring future disassembly



Product Code	Description
9980001	GENERAL PURPOSE CB Grease & Lubricant, 2oz
9980006	GENERAL PROTECTANT Aerosol Spray, 500ml
9980050	THREAD LOCK

ACCESSORIES & SPARE PARTS

REPLACEMENT LOCKS

A selection of replacement locks for our products.

Fitted to	Picture	Product Code	Model
HD SERIES WHEELCLAMPS SUPACLAMP DUO WHEELCLAMPS TRAILER CLAMP WHEELCLAMP (Oval style lock)		9000112	Lock with 2 Keys
		9000113	Lock with 3 Keys
		9000114	Lock with 4 Keys
		9000115	Lock with 5 Keys
		9000116	Lock with 6 Keys
		9000212	Lock with 2 Keys - Keyed Alike
		9000201	Extra Keys - Keyed Alike only
NEW DEFENDER WHEELCLAMPS (Round Style Lock)		9007313	Lock with 3 keys
		9007413	Lock with 3 Keys - Keyed Alike
		9002601	Extra Keys - Keyed Alike only
NEW DEFENDER WHEELCLAMPS (Older Oval style lock)		9001112	Lock with 2 keys - Oval style lock
SUPACLAMP DUO GOLD WHEELCLAMP (round)		9007113	Lock with 3 Keys
		9007213	Lock with 3 keys - Keyed Alike
		9002601	Extra Keys - Keyed Alike only
SUPACLAMP DUO SILVER WHEELCLAMP EYELOCKS (Round Style Lock)		9002113	Lock with 3 Keys
		9002213	Lock with 2 keys - Keyed Alike
		9002601	Extra Keys - Keyed Alike only
FORT HITCHLOCKS (excluding FORT GOLD versions)		9006113	Lock with 3 keys
		9006213	Lock with 3 keys - Keyed Alike
		9006201	Extra Keys - Keyed Alike only
FORT 2 GOLD HITCHLOCK (Round Style Lock)		9003113	Lock with 3 Keys
		9003213	Lock with 3 Keys - Keyed Alike
		9002601	Extra Keys - Keyed Alike only
ORIGINAL HL1, HL2 & HL3 HITCHLOCKS		9005112	Lock with 2 keys
		9005212	Lock with 2 keys - Keyed Alike
		9005201	Extra Keys - Keyed Alike only
HEAVY-DUTY LEG LOCKS		9004112	Lock with 2 keys
		9004212	Lock with 2 keys - Keyed Alike
TRAILER DOOR LOCK, QUAD SHIELD, FORT 30 GOLD, FORT 35 GOLD		9008113	Lock, push in with 3 keys
		9008213	Lock, push in with 3 keys - Keyed Alike
HEAVY DUTY SECURITY POSTS (round)		9007513	Lock with 3 keys
		9007613	Lock with 3 keys, Keyed Alike
		9002601	Extra Keys -Keyed Alike Only

Extra keys are available on some products at time of ordering a product or replacement lock, but we cannot guarantee to be able to offer replacement keys to specific numbers after initial order.

ACCESSORIES & SPARE PARTS

HITCH ACCESSORIES

9003313



9003413



9004712



9005712



Product Code	Model	Keys Supplied
9003313	SAS Ultimate Barrel Lock for Bradley Auto & Doublelock Hitch heads	3
9003413	SAS Ultimate Barrel Lock for Bradley Auto & Doublelock Hitch heads - Keyed Alike	3
9004712	Replacement Barrel Lock for AL-KO AK301 & AK351 Hitch heads	2
9005712	Replacement Barrel Lock for Knott Avonride Hitch heads	2
9220021	Black ABS Towball	

WHEELCLAMP ACCESSORIES & PARTS

9900011



9900031

9900034

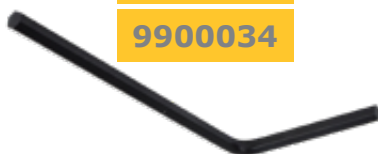

9900035



9120053



9150021

9120050

9120063

9120075



Product Code	Model
9900011	Case Only in Red, suitable for HD1, Supaclamp & Trailer Clamp (Specify product label when ordering)
9900031	SAS Trailer Clamp, smaller Allen Key
9900034	SAS Wheel Clamp, Allen Key, bent
9900035	SAS Wheel Clamp, Allen Key, straight
9120053	Pin & Bolt set for HD1
9150021	Refurb Kit for HD1 - Lock & 2 keys, Allen Key, Pin & Bolt
9120050	Extension Tube, straight 1" (25mm) suitable for HD1 & HD2
9120063	Extension Tube, straight 1.5" (37mm) suitable for HD1 & HD2
9120075	Extension Tube, straight 2" (50mm) suitable for HD1, HD2 & HD4

Other parts and accessories available on request – please ask.

PJB & SAS PROPERTY SECURITY ACCESSORIES & PARTS

8375085



8300071



9641044



9610013



9610014



9610023



9610024



9960047



9960010



9960016



9960041



9960032



9960033



9960034



Product Code	Model	To Fit
8375085	Replacement HD85-75 Hardened Steel Padlock, w 5 keys	Garage Defender
8300071	Replacement HD71 Round Solid Hardened Steel Padlock, w 5 keys	Garage Defender Master
9641044	Replacement Ground Socket and Lock, for Secure-A-Door	Secure-A-Door
9610013	Bolt Down Plate Only - Garage Defender	Garage Defender
9610014	Tarmac Fixing Plate - Garage Defender	Garage Defender
9610023	Bolt Down Plate Only - Garage Defender Master	Garage Defender Master
9610024	Tarmac Fixing Plate - Garage Defender Master	Garage Defender Master
9960047	Spruce Up Kit - inc. 2 End Caps & Label set	All Garage Defenders
9960010	10mm Masonry Drill Bit (pilot drill)	for Sleeve Anchor Bolts
9960016	16mm Masonry Drill Bit	for Sleeve Anchor Bolts
9960041	Fixing Kit - inc. 1x Security Bolt, 10 & 16mm Drill Bits & Allen Key	All Garage Defenders
9960032	2 Expandable Shield Anchor Security Bolts	All Garage Defenders
9960033	2 Expandable Shield Anchor Security Bolts, w. Allen Key & Ball Bearings	Ground Anchors
9960034	4 Expandable Shield Anchor Security Bolts, w. Allen Key & Ball Bearings	Ground Anchors & Security Post

THE SAS GREEN RANGE

We believe in offering security solutions that truly fit your requirements. Our green range is a highly visible, affordable alternative to our premium red range. It offers reliable entry-level wheel clamps and hitchlocks designed to fit the most common trailers, caravans, and vehicles.*

76 - 81

- 76 HITCH EYE LOCKS
- 77-79 HITCH LOCKS
- 80-81 WHEELCLAMPS

** For the highest level of security, we would still recommend our well-respected SAS heavy-duty red products, which are designed for maximum protection.*



SAS GREEN iLOCK

The SAS GREEN iLOCK is a versatile eye lock designed to fit a wide range of trailers using an eye type coupling.

A simple design using a main shaft fitted with a robust round padlock with enclosed shackle making it difficult to attack.

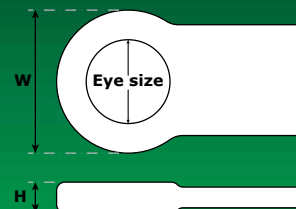

Product Code	Model	Fits unhitched	Fits hitched	Fits	Eye Dimensions	
					Eye Size	h
V283771	GREEN iLOCK Eye lock	✓	✗	Most 40 & 50mm eye couplings	40-60mm	Up to 35mm

SAS HD71 Round Padlock included - Replacement code 8300071 on page 60

SAS GREEN RANGE HITCHLOCKS

SAS GREEN AKS HITCHLOCK

The SAS GREEN AKS hitchlock is a robust yet lightweight security solution designed to protect your caravan or trailer. It's simple to install and is supplied with the SAS HD71 round steel padlock, complete with two keys for convenience.



This strong combination effectively immobilises your hitch, helping to deter tow-away theft and may even lower your insurance costs.

The bright green powder-coated finish not only looks great but also acts as a visual deterrent to potential thieves.

- › Strong steel box construction encloses coupling
- › Fully enclosed top section covers fitting bolts and hitch release handle
- › Box structure protecting hitch from weathering
- › Fits when Unhitched and Hitched (whilst Stationary)
- › Designed to Fit Al-Ko AKS 2004 & AKS 3004 Stabiliser Couplings fitted on most caravans
- › Will also fit some other Al-Ko hitch couplings, such as AK160, AK180, AK300 & AKS1300
- › Can be quickly and easily fitted, with hardened steel round padlock, supplied with 2 keys
- › Bright green powder coating enhances visibility, acting as a strong theft deterrent
- › ABS towball supplied to increase security whilst unhitched

Product Code	Model	Lock	Fits unhitched	Fits hitched
V277771	SAS GREEN AKS hitchlock	SAS HD71 Padlock Closed Shackle	✓	✓

SAS HD71 Round Padlock included - Replacement code 8300071 on page 60



SAS GREEN RANGE HITCHLOCKS

SAS GREEN HITCHLOCK

The VITAL and VALIANT are a quick, easy and lightweight hitch coupling lock to fit most 50mm ball style trailer hitch couplings



VITAL



2 Secure Cross Style Keys supplied for unlocking



Case hardened Solid Steel 12.6mm diameter top U bar, with 11 locking positions



Designed to fit most trailers with 50mm ball style coupling

THE SAS GREEN VITAL HITCHLOCK

- › A quick and easy coupling lock to deter trailer thieves.
- › Handy lightweight design
- › Universal design to fit most 50mm ball style trailer couplings.
- › Very quick to install without using keys
- › Locking in 11 positions, giving flexibility for use on many different couplings
- › Very visible with bright powder coating to deter thieves



VALIANT



Designed to fit most trailers with 50mm ball style coupling



2 Secure cross style keys supplied for unlocking

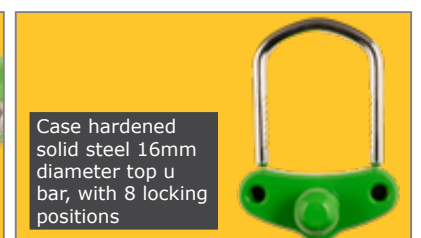

Case hardened solid steel 16mm diameter top u bar, with 8 locking positions

THE SAS GREEN VALIANT HITCHLOCK

- › Universal double-locking trailer coupling lock
- › A quick and easy coupling lock to deter thieves.
- › Robust case-hardened double locking top U bar
- › Double ratchet system, locking in 8 positions, giving flexibility for use on many different couplings
- › Very quick to install without using keys
- › Universal design to fit most 50mm ball style trailer couplings
- › Highly visible with bright powder coating to deter thieves
- › 2 secure cross-style keys supplied for unlocking

SAS GREEN VAULT HITCHLOCK

The VAULT hitchlock range is designed to fit many pressed steel hitches on both braked and unbraked trailers.



VAULT

COUPLING TRAILER LOCK

- › Secures your trailer to help prevent it being stolen, when not in use.
- › Quick and easy to fit
- › Robust steel construction with bright powder coating
- › Universal design to fit most trailer couplings
- › Highly visible to deter thieves
- › Hardened stainless steel disc padlock
- › Supplied with 3 keys



Strong closed shackle disc padlock



Two locking positions to fit a wide range of pressed steel couplings



Box design enclosing coupling

Product Code	Model	Lock	Fits unhitched	Fits hitched
V222765	SAS GREEN VITAL hitchlock	Single Locking on U Bar	✓	✗
V255767	SAS GREEN VALIANT hitchlock	Double Locking on U Bar	✓	✗
V266733	SAS GREEN VAULT hitchlock	Disc Padlock	✓	✗

See replacement disc padlock on page 56.



SAS GREEN RANGE WHEELCLAMPS

SAS GREEN V2 RANGE

Simple, lightweight, easy to use wheelclamp. Suitable for caravans, motorhomes, trailers, quad bikes, cars, and more.



- › Two sizes available to fit a wide range of tyre widths
- › Simple to use and can be fitted in seconds
- › Easy to operate integral push key lock, supplied with 2 keys for releasing
- › Unique design fully protects against driving away or removal by tyre deflation
- › Designed to secure your vehicle
- › Excellent visual & physical deterrent



SAS GREEN V3 RANGE

A simple wheel lock to prevent unwanted movement.



**V3
COMPACT**



V3

- › Two sizes available to fit a wide range of tyre widths
- › Quick and simple to fit
- › Easy to operate integral push key lock, supplied with 2 keys for releasing
- › 3 arm design, fully protects against driving away or removal by tyre deflation
- › Covers wheel bolts to avoid wheel removal
- › Insurance approved design
- › Fits over wheel trims on steel or alloy wheels
- › Excellent visual & physical deterrent

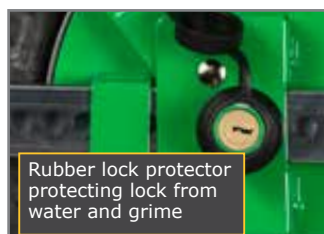

Rubber lock protector protecting lock from water and grime



Folds for easy storage

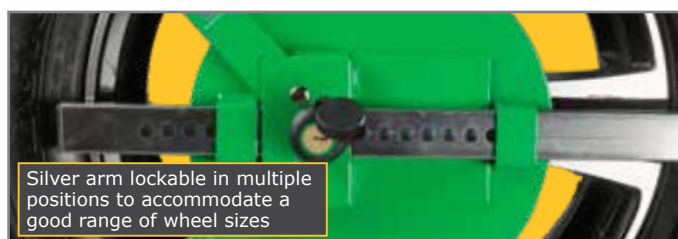

Silver arm lockable in multiple positions to accommodate a good range of wheel sizes



Product Code	Model	Steel Wheels	Alloy Wheels	Tyre Width (C)	Wheel Diameter Range (A)
V122795	GREEN V2 COMPACT Wheelclamp	✓	✓	85 - 165mm	N/A
V125795	GREEN V2 Wheelclamp	✓	✓	155 - 265mm	N/A
V133795	GREEN V3 COMPACT Wheelclamp	✓	✓	up to 145mm	450 - 580mm
V135795	GREEN V3 Wheelclamp	✓	✓	up to 215mm	550 - 720mm



NOTES

This image shows a full page of white paper with evenly spaced, light gray horizontal lines. The lines run from left to right across the entire width of the page, providing a guide for writing or drawing. There are no margins, text, or other markings present.

NOTES

VISIT WEBSITE FOR
 LATEST INFORMATION
www.sasproducts.com



TERMS & CONDITIONS

PAYMENT: All credit accounts are due for settlement 30 days nett from date of invoice. Goods must be paid for before despatch for all proforma accounts.

CARRIAGE CHARGES: Please ask for cost when ordering.

RETURNS: Unwanted returned items are subject to a minimum 20% handling charge, and prior authorisation must be given before returning via customer's carrier.

RECEIVING GOODS: Please ensure you sign carriers notes for the correct number of boxes received. All goods lost, delayed, or damaged in transit must be notified within 3 working days, otherwise we cannot accept any liability.

RETENTION OF TITLE: Passing of title. The property of all equipment sold by SAS Security Products Ltd shall remain within the company until such sums at the time owing to the company, under this or any other contract, have been paid in full. All subject to SAS Security Products Ltd's full Terms and Conditions, which are available on request.

OMISSIONS & ERRORS: Whilst every effort has been made to represent products correctly, SAS will seek to rectify any issues where possible, but will not take responsibility for any liability, arising from omissions and errors in this brochure.

E&OE.



SAS SECURITY PRODUCTS LTD
Sussex, England

+44 1444 675889
+44 1444 675889
sales@sasproducts.com
www.sasproducts.com

Company Registration No: 2701887
VAT Registration No: 729 1709 19



YOUR LOCAL SAS DEALER IS:

A large white rectangular box with a red border, intended for a local SAS dealer's name and address.